

02-2	SPINDLE	1	CERAMIC	φ4X29.7	P2331107	05	OUTER DRIVE RING	1		φ41X62.5	P2501413	07	SCREW CROSS RECESS HEAD	4	SUS304	M3X22	P9111721
02-1	FRONT THRUST PAD	1	RULON	φ9Xφ4.2X1.2	A2221580	04-1	INNER MAGNET	1		φ18X12	P2441115	06	w/t P.W.(φ6Xφ3.2X10.5)	1	FKM	φ44.5Xφ2	S45
02	FRONT CASING ASS'Y	1	PPS	φ54X35	P2201370	04	IMPELLER VANE	1	PPG	φ40X22.5	P2401035	05-2	OUTER MAGNET	1	FERRITE	φ38Xφ25X10	P2521094
01	MOTOR	100~120V,200~240V . 5W,1φ,2P				03	REAR CASING	1	PPS	φ54X28.5	P2301369	05-1	MAGNET HOUSING	1	FERRITE	φ41X59.5	P1201373
NO	PART NAME	Q'TY	MATERIAL	NOTE	DWG. NO.	NO	PART NAME	Q'TY	MATERIAL	NOTE	DWG. NO.	NO	PART NAME	Q'TY	MATERIAL	NOTE	DWG. NO.

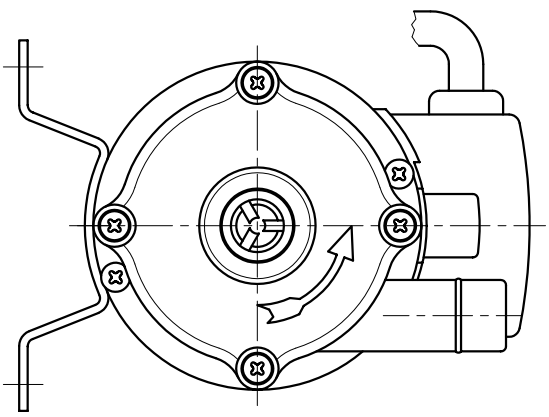
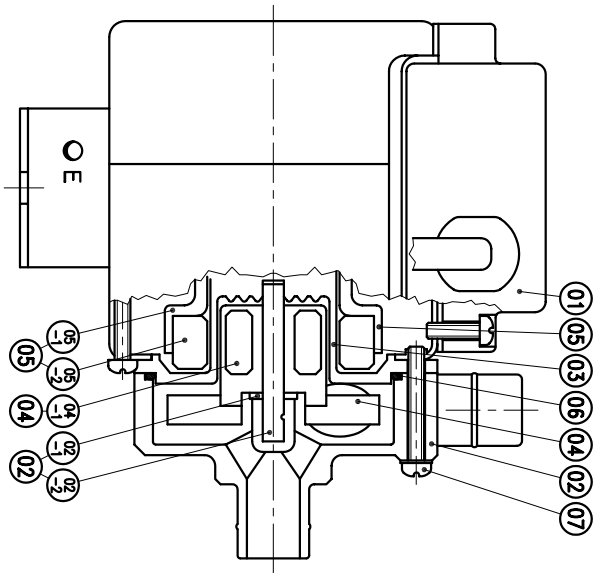

G : 1/2"X 1/2"  
NPT : 1/2"X 1/2"

APPROVED	MDL. NAME	NH-3PX
CHECK	DWG. NAME	CONSTRUCTION DRAWING
DESIGN	DWG. NO.	B2001182
DR.BY		A3

TPW  
HONG YUAN

PAN WORLD CO., LTD.  
パンワールド株式会社