

NO	PART NAME	Q'TY	MATERIAL	NOTE	PART NO.
05-1	RING	1	S45C	φ48X9.8	
05	OUTER DRIVE RING	1	FCD-45	φ122X205	1003511800
04	IMPELLER ASS'Y	1	PPG		1003411000
03	REAR CASING	1	PPG	φ186.5X141	1003912360
02	FRONT CASING	1	PPG	φ202X113	1003212300
01	BRACKET	1	FC-20	φ202X208	1003013101

15	HEAXGON SOCKET BOLT	4	SUS304	1/2" - 13X1"	
14	w/t SPRING WASHER	1	S435	M6X10	
13	SET SCREW	2	S435	M8X10	
12	HEAXGON HEAD BOLT	5	SUS304	M10X35	
11	w/t PLAIN WASHER	3	SUS304	M10X65	
10	O. RING	1	FKM	G175	1003012302
09-2	PTFE BOARD	1	PTFE	281.8X122.9	
09-1	PTFE BOARD	1	PTFE	278.6X122.9	
09	PTFE BOARD	2	PTFE	LX122.9	
08	REAR CASING COVER	1	PPG	φ164X137	1004912308
07	INNER DRIVE RING	1	PPG	φ79.6X124	
06	BEARING ASS'Y	1	CERAMIC RULON CARBON	φ44X46.5	1003210803 1003210802 1003210801

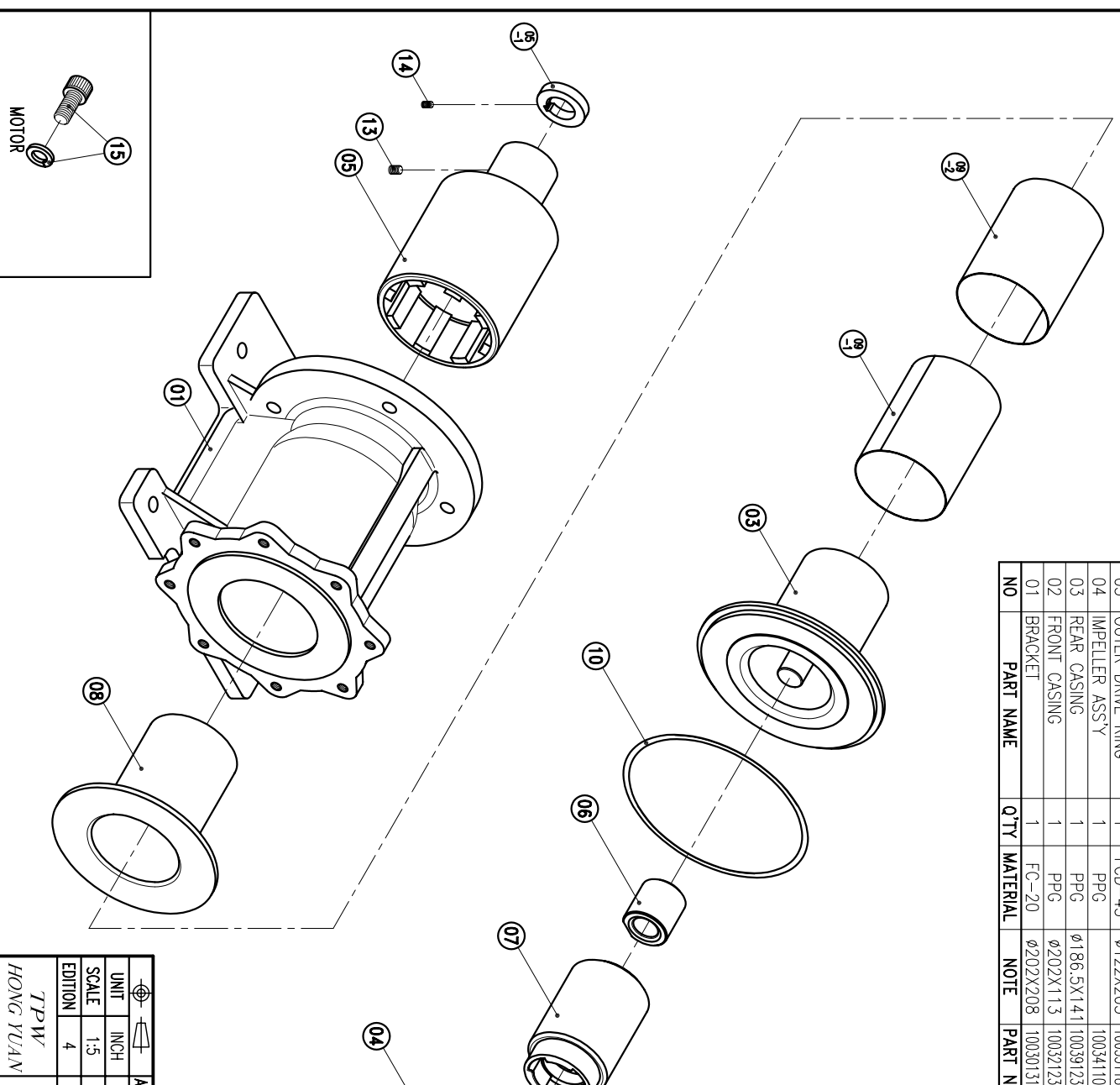

G : 1 1/2" X 2"
NPT : 1 1/2" X 2"

APPROVED	CHECK	DESIGN	DR.BY	MDL. NAME	DWG. NAME	DWG. NO.	DECOMPOSITION	DRAWING
05 03 05	05 03 05	04 18 02	05 03 05 BECKY	NH-405PW (NEMA)		E3453068		A3

TPW
HONG YUAN



PAN WORLD CO., LTD.
パンワールド株式会社