

03-2	REAR THRUST PAD	1	CERAMIC	037X8	P2329184	07-1	INNER MAGNET	1	Nd-Fe-B	076X93	P2449491	17	HEXAGON SOCKET BOLT	4	SUS304	1/2"-13X3/4"	A9119381
03-1	SPINDLE HOLDER	1	PPG	041X131	P2379483	07	INNER DRIVE RING	1	PPG	079.6X124	P2439018	16	COUNTER SUNK HEAD BOLT	4	S435	M10X25	A9119375
03	REAR CASING	1	PPG	0240X141	P2309141	06-1	BEARING	1	CERAMIC CARBON RULON	036X45	P2469183 P2469773 A2469348	15	EYEBOLT	1	S41C	M12X20	P9114152
02-6	SLEEVE	2	SUS304	020X21.5	A2273365	06	BEARING ASS'Y	1	ETFE	044X46.5	A2469553	14	SET SCREW	1	S435	M6X10	P9116430
02-5	SLEEVE	6	SUS304	020X50	A2273365	05-1	RING	1	S435	048X9.8	P2579342	13	SET SCREW	2	S435	M8X10	P9119160
02-4	RELIEF PLATE	1	FC-20	0261X12	A2273364	05	OUTER DRIVE RING	1	FCD-45	0122X20	P2509341	12	HEXAGON HEAD BOLT	8	SUS304	M10X110	P9113080
02-3	FLANGE	1	PPG	65A	P2233892	04-3	IMPELLER COVER	1	PPG	0175X20	P2454028	11	O. RING	1	FKM	054.4X03.1	G55
02-2	FRONT THRUST PAD	1	PPG	80A	P2233893	04-2	MOUTH RING	1	PPG	0104X9	P2424412	10	O. RING	1	FKM	084.4X03.1	G85
02-1	FRONT THRUST PAD	1	CERAMIC	0104X9	P2224475	04-1	IMPELLER NOUWENON	1	RULON	0175X44	P2414022	09	O. RING	1	FKM	0219.3X05.7	G220
02	FRONT CASING	1	PPG	0261X148	A2203366	04	IMPELLER ASS'Y	1	PPG	0175X44	A2403119	08	BACK UP RING	1	SPCC	0209X5.5	P2114123
01-1	TRANSITION FLANGE	1	FC-20	0228.6X18	P2179307	03-4	O. RING	1	FKM	024.4X03.1	G25	09	O. RING	1	FKM	0219.3X05.7	G220
01	BRACKET	1	FC-20	0261X208	A2123377	03-3	SPINDLE	1	CERAMIC	025X125	P2339005	08	BACK UP RING	1	SPCC	0209X5.5	P2114123

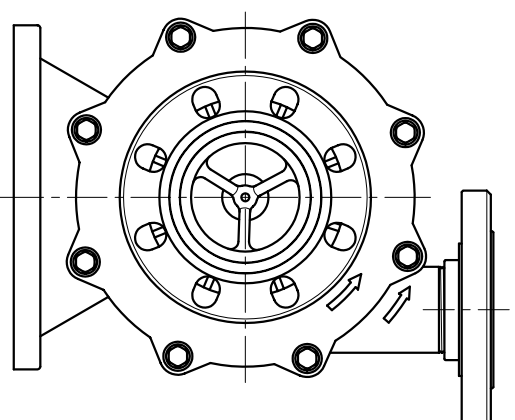

APPROVED		MDL NAME	NH-655PW (NEMA)
CHECK	05 03 05	DWG. NAME	CONSTRUCTION DRAWING
DESIGN	02 18 00	DWG. NO.	E2653074
DR.BY	05 03 05 BECKY		A3

TPW
HONG YUAN

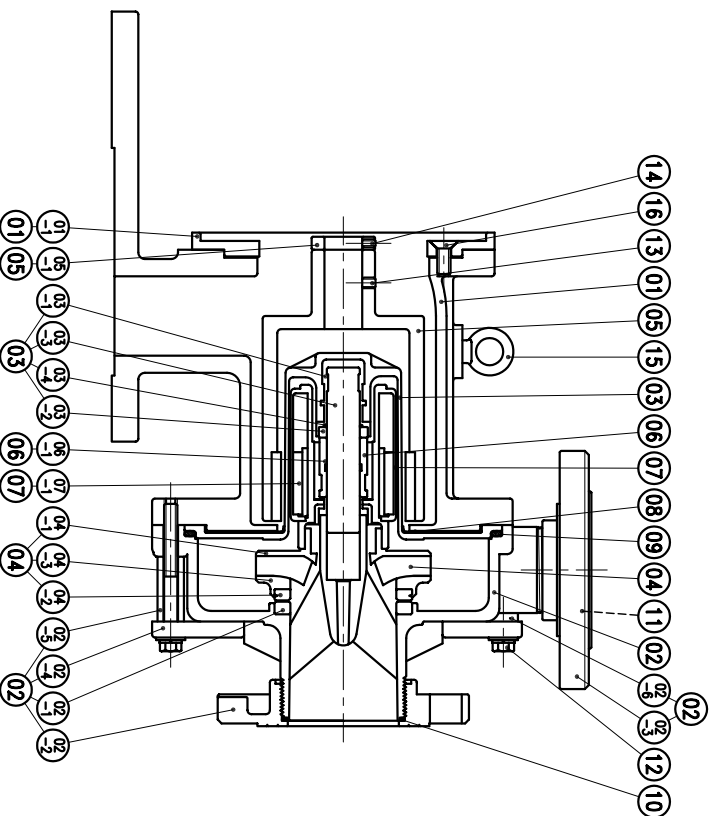

PAN WORLD CO., LTD.
パンワールド株式会社