

NO	PART NAME	QTY	MATERIAL	NOTE	DWG. NO.	NO	PART NAME	QTY	MATERIAL	NOTE	DWG. NO.
03-4	O. RING	1	FKM	φ24.4Xφ3.1	G25	07-1	INNER MAGNET	1	ST-FERRITE	φ76X93	P2449490
03-3	SPINDLE	1	CERAMIC	φ25X125	P2339005	07	INNER DRIVE RING	1	PPG	φ79.6X124	P2439018
03-2	REAR THRUST PAD	1	CERAMIC	φ37X8	P2329184	06-1	BEARING	1	CERAMIC CARBON RULON	φ36X45	P2469183 P2469773 A2469348
03-1	SPINDLE HOLDER	1	PPG	φ41X131	P2379483	06	BEARING ASS'Y	1	ETFE	φ44X46.5	A2469553
03	REAR CASING	1	PPG	φ186.5X141	P2309178	05-1	RING	1	S45C	φ44X10	P2579340
02-3	FLANGE	1	PPG	40A	P2233172	05	OUTER DRIVE RING	1	FCD-45	φ118X183.5	P2509335
02-2	FLANGE	1	PPG	50A	P2233411	04-3	IMPELLER COVER	1	PPG	φ160X27.8	P2459060
02-1	FRONT THRUST PAD	1	CERAMIC	φ72X9	P2229315	04-2	MOUTH RING	1	RULON	φ63X8	P2429006
02	FRONT CASING	1	PPG	φ202X113	P2203180	04-1	IMPELLER NOUМЕНON	1	PPG	φ160X44	P2419024
01	BRACKET	1	FC-20	φ202X196.5	A2123148	04	IMPELLER ASS'Y	1	PPG	φ160X44	P2409177
						08	BACK UP RING	1	SUS304	φ164X5.5	P2119175
						09	O. RING	1	FKM	φ49.4Xφ3.1	G50
						10	O. RING	1	FKM	φ174.3Xφ5.7	G175
						11	O. RING	1	FKM	φ44.4Xφ3.1	G45
						12	HEXAGON HEAD BOLT	3	SUS304	M10X65	P9113080
						13	w/1 P.W.(φ21Xφ10.5X12)	5	SUS304	M10X35	P9113080
						14	SET SCREW	2	S435	M8X10	P9119160
						15	SET SCREW	1	S435	M6X10	P9116430
						16	HEXAGON SOCKET BOLT	4	SUS304	3/8"-16X1"	A9119380
							w/1 S.W.(3/8") (MOTOR)				

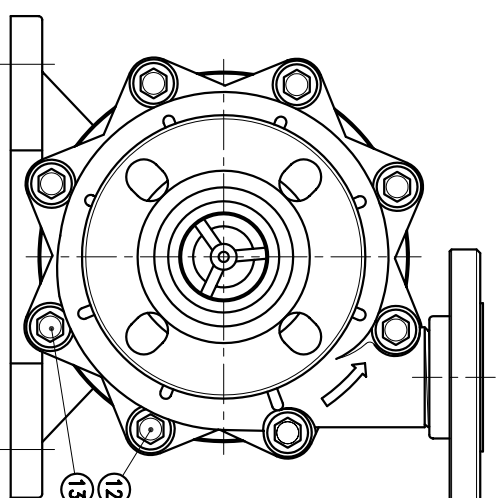

APPROVED		MDL NAME	NH-402PW (NEMA)
CHECK	02.16.04	DWG. NAME	CONSTRUCTION DRAWING
DESIGN	10.23.96	DWG. NO.	E2423071
DRBY	02.16.04 BECKY		A3

TPW
HONG YUAN

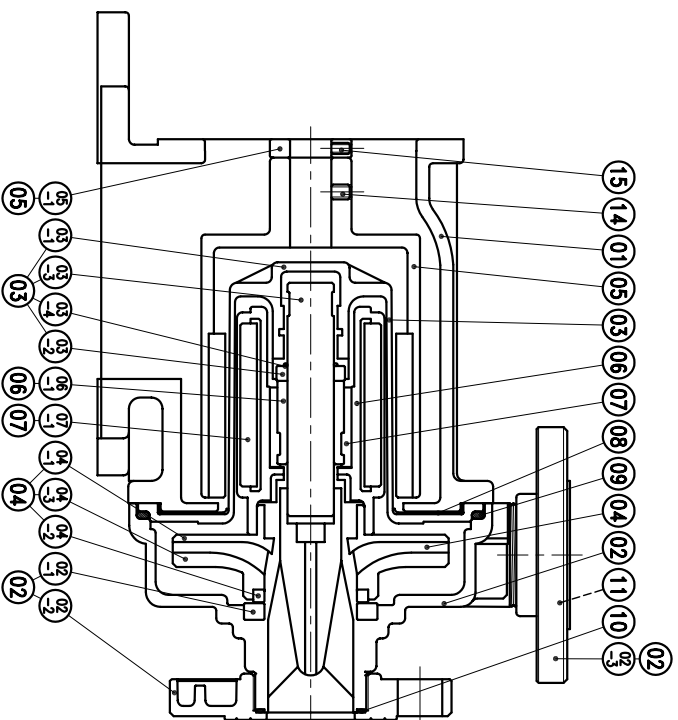

PAN WORLD CO., LTD.
パンワールド株式会社