

04	IMPELLER ASS'Y	1	PPG	P2409050	07-1	INNER MAGNET	1	ST-FERRITE	Ø76X47	P2449053	14	HEXAGON SOCKET BOLT	SUS304	3/8" - 16X1"	A9119380		
03-4	O. RING	1	FKM	Ø19.8XØ2.4	07	INNER DRIVE RING	1	PPG	Ø79.6X71	P2439077	14	w/1 S.W.(3/8") (MOTOR)	SUS304				
03-3	SPINDLE	1	CERAMIC	Ø20X65	06-1	BEARING	1	CERAMIC	Ø52X28	P2469770	13	SET SCREW	S435	M6X10	P9116430		
03-2	REAR THRUST PAD	1	CERAMIC	Ø36X6.5				CARBON RULON		P2469771	12	SET SCREW	S435	M8X10	P9119160		
03-1	SPINDLE HOLDER	1	PPG	Ø40X68	06	BEARING ASS'Y	1	ETFE	Ø44X31	P2469076	11	HEXAGON HEAD BOLT	SUS304	M8X30	P9113079		
03	REAR CASING	1	PPG	Ø174X92.5	05-1	RING	1	S45C	Ø40X7.5	P2579333	10	w/1 P.W.(Ø17XØ8.4X11.6)	SUS304				
02-1	FRONT THRUST PAD	1	CERAMIC	Ø58X8.5	05	OUTER DRIVE RING	1	FCD-45	Ø123X127.5	P2509334	10	HEXAGON HEAD BOLT	SUS304	M8X55	P9113079		
02	FRONT CASING	1	PPG	Ø185X124	04-3	IMPELLER COVER	1	PPG	Ø124X18	P2459052	10	w/1 P.W.(Ø17XØ8.4X11.6)	SUS304				
01	BRACKET	1	FC-20	Ø185X140.4	04-2	MOUTH RING	1	RULON	Ø52X7	P2429098	09	O. RING	FKM	Ø159.3XØ5.7	G160		
NO	PART NAME	Q'TY	MATERIAL	NOTE	DWG. NO.	NO	PART NAME	Q'TY	MATERIAL	NOTE	DWG. NO.	NO	PART NAME	Q'TY	MATERIAL	NOTE	DWG. NO.
						04-1	IMPELLER NOUМЕНON	1	PPG	Ø124X33	P2419051	08	BACK UP RING	SUS304	Ø150X5.5	P2119054	

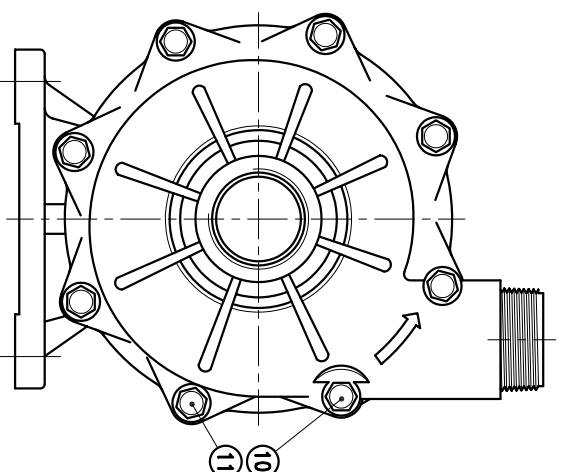
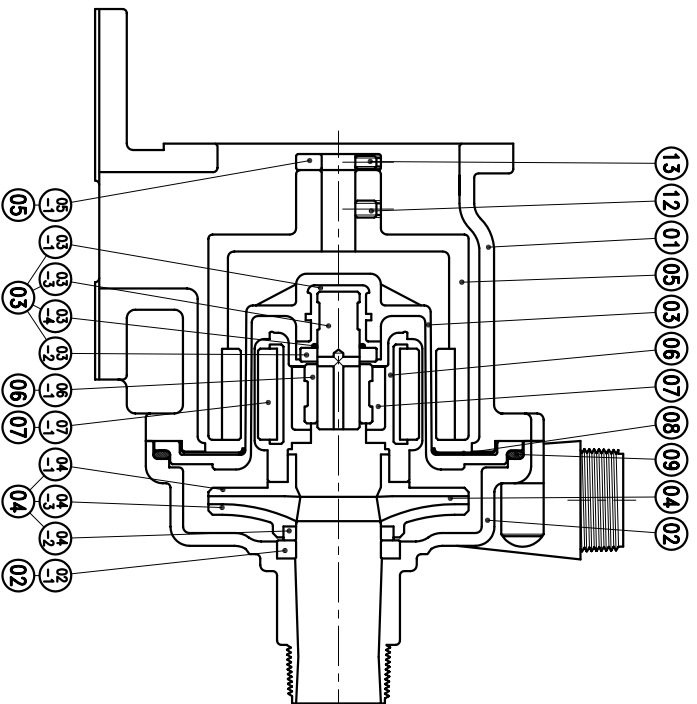

G : 1 1/2" X 1 1/2"
NPT : 1 1/2" X 1 1/2"

APPROVED		MDL NAME	NH-401PW (NEMA)
CHECK	04.02.05	DWG. NAME	CONSTRUCTION DRAWING
DESIGN	10.22.96	DWG. NO.	E2413079
DR.BY	04.02.05 BECKY		A3

TPW
HONG YUAN



PAN WORLD CO., LTD.
パンワールド株式会社