

04	IMPELLER ASS'Y	1	PPG	P2409074	07	INNER DRIVE RING	1	PPG	Ø79.6X71	P2439077	14	HEXAGON SOCKET BOLT w/1 S.W.(3/8") (MOTOR)	4	SUS304	3/8"-16X1" A9119380		
03-4	O. RING	1	FKM	Ø19.8XØ2.4		BEARING	1	CERAMIC CARBON	Ø32X28	P2469770	13	SET SCREW	1	S435	M6X10 P9116430		
03-3	SPINDLE	1	CERAMIC	Ø20X65	P20	BEARING ASS'Y	1	ELFE RULON	Ø44X31	P2469771 A2469347	12	SET SCREW	2	S435	M8X10 P9119160		
03-2	REAR THRUST PAD	1	CERAMIC	Ø36X6.5	P2329095	OUTER DRIVE RING	1	S45C	Ø37.5X17.5	P2579332	11	HEXAGON HEAD BOLT w/1 P.W.(Ø17XØ8.4X11.6)	5	SUS304	M8X30 P9113079		
03-1	SPINDLE HOLDER	1	PPG	Ø40X68	P2379093	IMPELLER COVER	1	PPG	Ø105X18	P2459099	10	HEXAGON HEAD BOLT w/1 P.W.(Ø17XØ8.4X11.6)	1	SUS304	M8X55 P9113079		
03	REAR CASING	1	PPG	Ø164X92.5	P2309073	MOUTH RING	1	RULON	Ø52X7	P2429098	09	O. RING	1	FKM	Ø149.3XØ5.7 G150		
02-1	FRONT THRUST PAD	1	CERAMIC	Ø58X8.5	P2229092	IMPELLER NOLU-MENON	1	PPG	Ø105X30	P2419097	08	BACK UP RING	1	SUS304	Ø140X5.5 P2119089		
02	FRONT CASING	1	PPG	Ø174X110	P2203102		1				07-1	INNER MAGNET	1	FERRITE	Ø76X44.5 P2449101		
01	BRACKET	1	FC-20	Ø174X140.4 A2123146			1										
NO	PART NAME	Q'TY	MATERIAL	NOTE	DWG. NO.	NO	PART NAME	Q'TY	MATERIAL	NOTE	DWG. NO.	NO	PART NAME	Q'TY	MATERIAL	NOTE	DWG. NO.

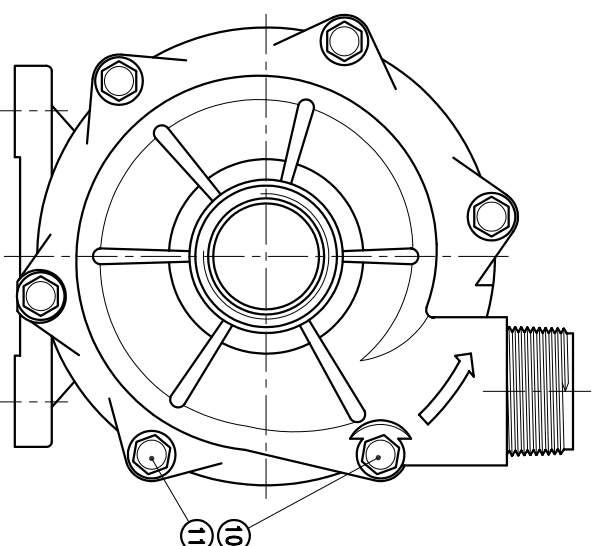
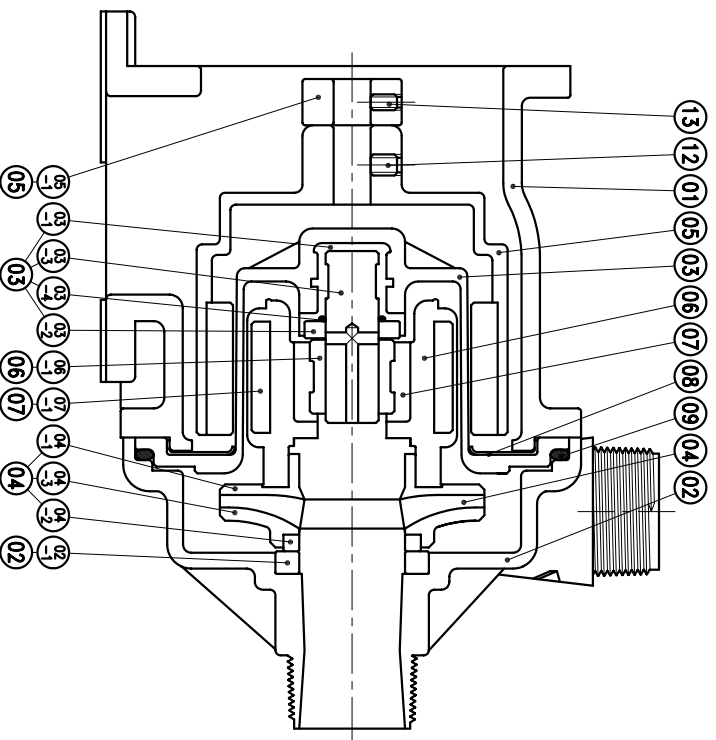

G : 1 1/2" X 1 1/2"
NPT : 1 1/2" X 1 1/2"

APPROVED	CHECK	04 02 05	MDL NAME	NH-400PW (NEMA)
SCALE	DESIGN	10 22 96	DWG. NAME	CONSTRUCTION DRAWING
EDITION	DR.BY	04 02 05 BECKY	DWG. NO.	E2403078
				A3

TPW
HONG YUAN



PAN WORLD CO., LTD.
パンワールド株式会社