

NO	PART NAME	QTY	MATERIAL	NOTE	PART NO.
05-1	RING	1	S45C	φ37.5X17.5	
05	OUTER DRIVE RING	1	ADC-12	φ117.5X117	1003011800
04	IMPELLER ASS'Y	1	ETFE		1004511314
03	REAR CASING	1	ETFE		1004510201
02	FRONT CASING	1	ETFE		1004510200
01	BRACKET	1	FC-20	φ174X118	1003010100

NO	PART NAME	QTY	MATERIAL	NOTE	PART NO.
14	HEAXGON SOCKET BOLT	4	SUS304	3/8" - 16X1"	
13	SET SCREW	1	S435	M6X10	
12	SET SCREW	2	S435	M8X10	
11	HEAXGON HEAD BOLT	5	SUS304	M8X30	
10	HEAXGON HEAD BOLT	1	SUS304	M8X55	
09	O. RING	1	FKM	G150	1013012300
08	BACK UP RING	1	SUS304	φ140X5.5	1003010300
07	INNER DRIVE RING	1	ETFE	φ79.6X71	
06	BEARING ASS'Y	1	CERAMIC FLUON CARBON	φ44X31	1004510814 1004510813 1004510812 1004510811

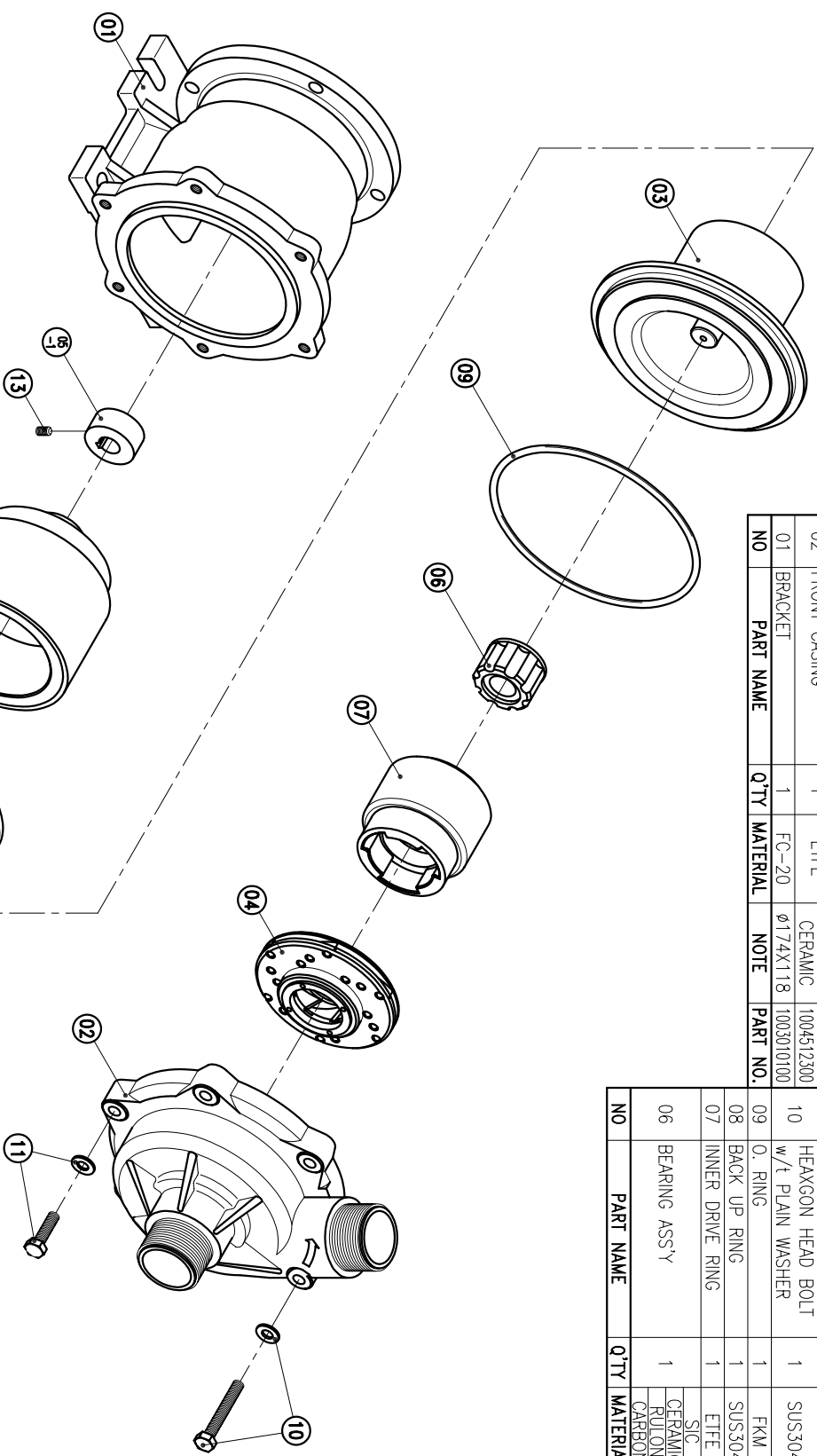

G : 1 1/2" X 1 1/2"  
NPT : 1 1/2" X 1 1/2"

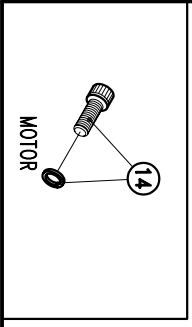

APPROVED	CHECK	DESIGN	DR.BY	MDL. NAME	DWG. NAME	DWG. NO.	EDITION
	04.02.05	07.10.97	04.02.05 BECKY	NH-400PW-F(NEMA)	DECOMPOSITION DRAWING	E3403026	3

TPW  
HONG YUAN

PAN WORLD CO., LTD.  
パンワールド株式会社