

NO	PART NAME	Q'TY	MATERIAL	NOTE	DWG. NO.	NO	PART NAME	Q'TY	MATERIAL	NOTE	DWG. NO.
03-2	REAR THRUST PAD	1	SIC	037X8	P2329188	07	INNER DRIVE RING	1	ETFE	079.6X124	P2439018
03-1	SPINDLE HOLDER	1	CERAMIC		P2329184				SIC		P2469772
03	REAR CASING	1	ETFE	041X131	P2379483	06-1	BEARING	1	CERAMIC CARBON RULON	036X45	P2469183 P2469773
02-6	SLEEVE	2	SUS304	0240X141	P2309141	06	BEARING ASS'Y	1	ETFE	044X46.5	A2469553
02-5	SLEEVE	6	SUS304	020X50	A2273365	05-1	RING	1	S435	048X9.8	P2579342
02-4	RELIEF PLATE	1	FC-20	0261X12	A2273364	05	OUTER DRIVE RING	1	FCD-45	0122X205	P2509341
02-3	FLANGE	1	ETFE	65A	P2233892	04-3	IMPELLER COVER	1	ETFE	0175X20	P2454028
02-2	FLANGE	1	ETFE	80A	P2233893	04-2	MOUTH RING	1	RULON	0104X9	P2424412
02-1	FRONT THRUST PAD	1	SIC	0104X9	P2224475	04-1	IMPELLER NOUМЕНON	1	ETFE	0175X44	P2414022
02	FRONT CASING	1	CERAMIC		A2203366	04	IMPELLER ASS'Y	1	ETFE	024.4X03.1	A2403119
01-1	TRANSITION FLANGE	1	FC-20	0228.6X18	P2179307	03-4	O. RING	1	FKM	G25	G25
01	BRACKET	1	FC-20	0261X208	A2123078	03-3	SPINDLE	1	CERAMIC	025X125	P2339005
						107-1	INNER MAGNET	1	Nd-Fe-B	076X93	P2449491
						17	HEXAGON HEAD BOLT	4	SUS304	1/2"-13X3/4"	A9119381
						16	w/t S.W.(1/2")(MOTOR) COUNTER SUNK HEAD BOLT	4	S435	M10X25	A9119375
						15	EYEBOLT	1	S41C	M12X20	P9114152
						14	SET SCREW	1	S435	M6X10	P9116430
						13	SET SCREW	2	S435	M8X10	P9119160
						12	HEXAGON HEAD BOLT w/t P.W.(022x010X12)	8	SUS304	M10X110	P9113080
						11	O. RING	1	FKM	054.4X03.1	G55
						10	O. RING	1	FKM	084.4X03.1	G85
						09	O. RING	1	FKM	0219.3X05.7	G220
						08	BACK UP RING	1	SUS304	0209X5.5	P2114123

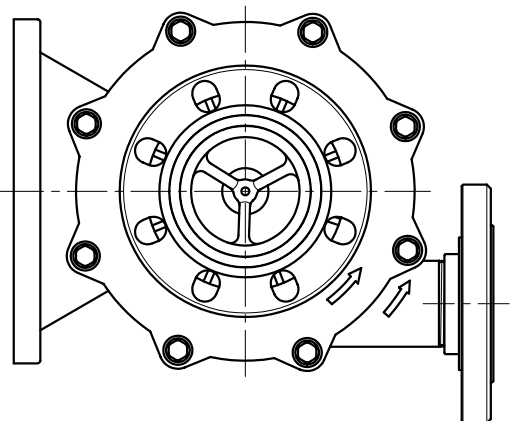

APPROVED	CHECK	05 03 05	MDL NAME	NH-655PW-F (NEMA)
SCALE	DESIGN	02 18 00	DWG. NAME	CONSTRUCTION DRAWING
EDITION	DR.BY	05 03 05 BECKY	DWG. NO.	E2653086
				A3

TPW
HONG YUAN

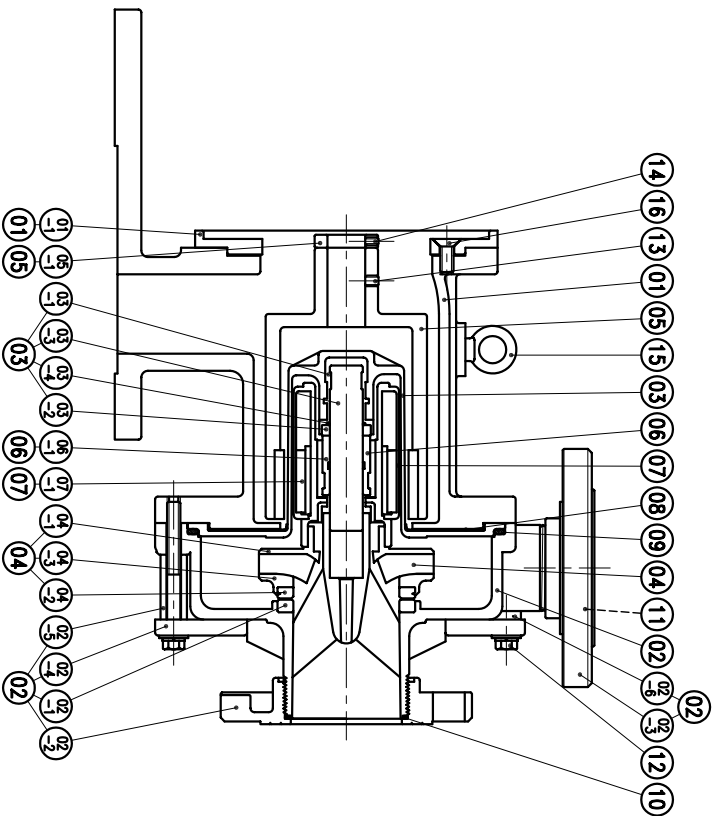

PAN WORLD CO., LTD.
パンワールド株式会社