

| NO | PART NAME | Q'TY | MATERIAL | NOTE | DWG. NO. | NO | PART NAME | Q'TY | MATERIAL | NOTE | DWG. NO. | | | | |
|------|-------------------|------|----------|------------|----------|------|-------------------|------|----------------------|-----------------------------------|----------|---------------------|---|--------|---------------------|
| 04-1 | IMPELLER NOUМЕНON | 1 | ETFE | φ160X44 | P2419024 | 08-2 | PIPE | 1 | HASTELLOY | φφ90.4X127.5A2119716 | 15 | HEXAGON SOCKET BOLT | 4 | SUS304 | 1/2"-13X1" A9119381 |
| 04 | IMPELLER ASS'Y | 1 | ETFE | | P2409029 | 08-1 | BACK UP RING | 1 | SUS304 | φ164X5.5 A2119714 | 14 | SET SCREW | 1 | S435 | M6X10 P9116430 |
| 03-4 | O. RING | 1 | FKM | φ24.4Xφ3.1 | G25 | 08 | REAR CASING COVER | 1 | | φ164X137 A2119717 | 13 | SET SCREW | 2 | S435 | M8X10 P9119160 |
| 03-3 | SPINDLE | 1 | SIC | φ25X125 | P2339005 | 07-1 | INNER MAGNET | 1 | Nd-Fe-B | φ76X93 P2449491 | 12 | HEXAGON HEAD BOLT | 5 | SUS304 | M10X35 P9113080 |
| 03-2 | REAR THRUST PAD | 1 | CERAMIC | | | 07 | INNER DRIVE RING | 1 | ETFE | φ79.6X124 P2439018 | 11 | HEXAGON HEAD BOLT | 3 | SUS304 | M10X65 P9113080 |
| 03-1 | SPINDLE HOLDER | 1 | SIC | φ37X8 | P2329188 | 06-1 | BEARING | 1 | CERAMIC CARBON RULON | φ36X45 P2469183 P2469773 A2469348 | 10 | O. RING | 1 | FKM | φ174.3Xφ5.7 G175 |
| 03 | REAR CASING | 1 | ETFE | φ186.5X140 | P2309737 | 06 | BEARING ASS'Y | 1 | ETFE | φ44X46.5 A2469553 | 09-2 | PTFE BOARD | 1 | PTFE | 281.8X122.9A2119713 |
| 02-1 | FRONT THRUST PAD | 1 | SIC | φ72X9 | P2229315 | 05-1 | RING | 1 | S45C | φ48X9.8 P2579342 | 09-1 | PTFE BOARD | 1 | PTFE | 278.6X122.9A2119713 |
| 02 | FRONT CASING | 1 | ETFE | φ202X113 | P2203180 | 05 | OUTER DRIVE RING | 1 | FCD-45 | φ122X205 P2509341 | 09 | PTFE BOARD | 2 | PTFE | LX122.9 A2119713 |
| 01 | BRACKET | 1 | FC-20 | φ202X221 | A2123121 | 04-2 | MOUTH RING | 1 | RULON | φ63X8 P2429006 | 08-3 | COVER | 1 | SUS304 | φ90.4X12 A2119715 |

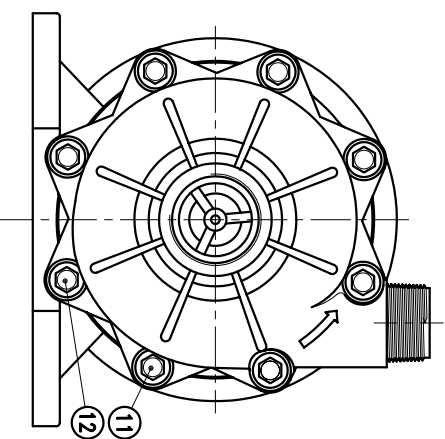
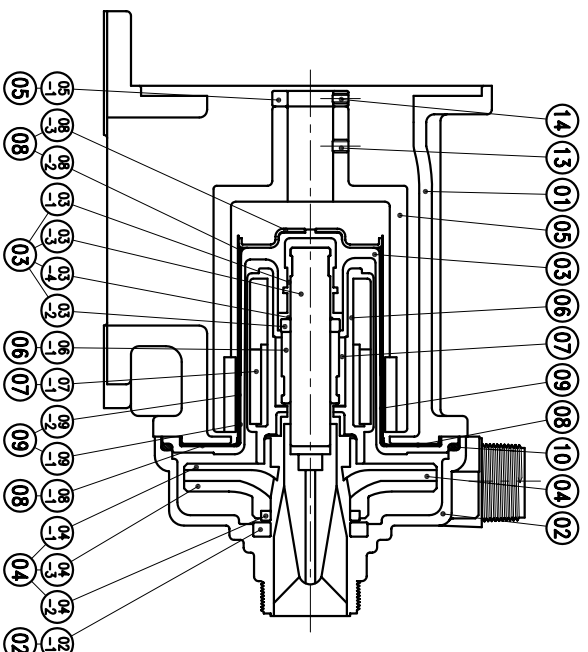

G : 1 1/2" X 2"
NPT : 1 1/2" X 2"

| | | | | |
|----------|--------|----------------|-----------|----------------------|
| APPROVED | CHECK | 05 03 05 | MDL NAME | NH-405PW-F (NEMA) |
| SCALE | DESIGN | 11 23 96 | DWG. NAME | CONSTRUCTION DRAWING |
| EDITION | DR.BY | 05 03 05 BECKY | DWG. NO. | E2453094 |
| | | | | A3 |

TPW
HONG YUAN

PAN WORLD CO., LTD.
パンワールド株式会社