

NO	PART NAME	Q'TY	MATERIAL	NOTE	DWG. NO.	NO	PART NAME	Q'TY	MATERIAL	NOTE	DWG. NO.
03-3	SPINDLE	1	SIC CERAMIC	Ø20X65	P2339096	06-1	BEARING	1	SIC CERAMIC RULON	Ø32X28	P2469100 P2469170 P2469171 P2469347
03-2	REAR THRUST PAD	1	SIC CERAMIC	Ø36X6.5	P2329095	06	BEARING ASS'Y	1	ETFE	Ø44X31	P2469076
03-1	SPINDLE HOLDER	1	ETFE	Ø40X68	P2379093	05-1	RING	1	S45C	Ø40X7.5	P2579333
03	REAR CASING	1	ETFE	Ø174X92.5	P2309020	05	OUTER DRIVE RING	1	FCD-45	Ø123X127.5	P2509334
02-1	FRONT THRUST PAD	1	SIC CERAMIC	Ø58X8.5	P2229092	04-3	IMPELLER COVER	1	ETFE	Ø124X18	P2459052
02	FRONT CASING	1	ETFE	Ø185X124	P2203048	04-2	MOUTH RING	1	RULON	Ø52X7	P2429098
01	BRACKET	1	FC-20	Ø185X140.4 A2123147	P2203048	04-1	IMPELLER NOUМЕНON	1	ETFE	Ø124X33	P2419051
						04	IMPELLER ASS'Y	1	ETFE		P2409050
						03-4	O. RING	1	FKM	Ø19.8XØ2.4	P20
						14	HEXAGON SOCKET BOLT w/1 S.W.(3/8") (MOTOR)	4	SUS304	3/8" - 16X1"	A9119380
						13	SET SCREW	1	S435	M6X10	P9116430
						12	SET SCREW	2	S435	M8X10	P9119160
						11	HEXAGON HEAD BOLT w/1 P.W.(Ø17XØ8.4X11.6)	6	SUS304	M8X30	P9113079
						10	HEXAGON HEAD BOLT w/1 P.W.(Ø17XØ8.4X11.6)	2	SUS304	M8X55	P9113079
						09	O. RING	1	FKM	Ø159.3XØ5.7	G160
						08	BACK UP RING	1	SUS304	Ø150X5.5	P2119054
						07-1	INNER MAGNET	1	Sr-FERRITE	Ø76X47	P2449053
						07	INNER DRIVE RING	1	ETFE	Ø79.6X71	P2439077

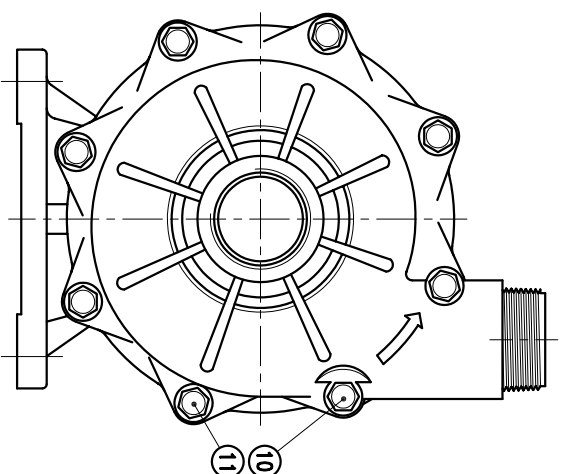
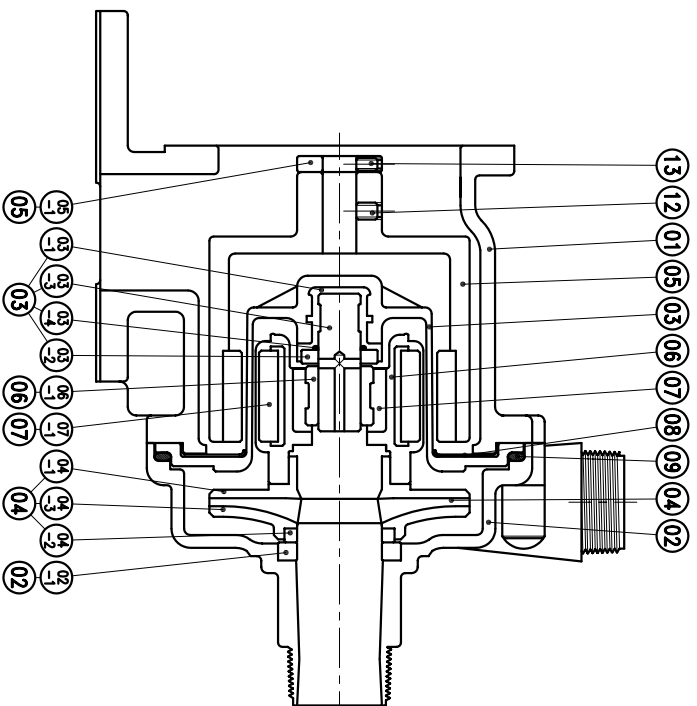

G : 1 1/2" X 1 1/2"
NPT : 1 1/2" X 1 1/2"

APPROVED	CHECK	DESIGN	DRBY	MDL NAME	DWG. NAME	DWG. NO.
	04 02 05	10 22 96	04 02 05 BECKY	NH-401PW-F (NEMA)	CONSTRUCTION DRAWING	E2413091
UNIT	INCH	SCALE	EDITION			
		2.5	3			

TPW
HONG YUAN
PAN WORLD CO., LTD.
PANワールド株式会社