

03-2	REAR THRUST PAD	1	CERAMIC	036X6.5	P2329095	06-1	BEARING	1	SIC	032X28	P2489100	15	HEXAGON SOCKET BOLT w/1 S.W.(3/8") (MOTOR)	4	SUS304	3/8" - 16X1"	A9119380
03-1	SPINDLE HOLDER	1	ETFE	040X68	P2379093	06	BEARING ASS'Y	1	ETFE	044X31	P2469076	14	SET SCREW	1	S435	M6X10	P9116430
03	REAR CASING	1	ETFE	0174X92.5	P2309020	05-1	RING	1	S45C	040X7.5	P2579333	13	SET SCREW	2	S435	M8X10	P9119160
02-2	FLANGE	2	ETFE	40A	P2233172	05	OUTER DRIVE RING	1	FCD-45	0123X127.5	P2509334	12	HEXAGON HEAD BOLT w/1 P.W.(017X08.4X11.6)	6	SUS304	M8X30	P9113079
02-1	FRONT THRUST PAD	1	SIC	058X8.5	P2229092	04-3	IMPELLER COVER	1	ETFE	0124X18	P2459052	11	HEXAGON HEAD BOLT w/1 P.W.(017X08.4X11.6)	2	SUS304	M8X55	P9113079
02	FRONT CASING	1	ETFE	0185X124	P2203048	04-2	MOUTH RING	1	RULON	052X7	P2429098	10	O. RING	1	FKM	0159.3X05.7	G160
01	BRACKET	1	FC-20	0185X140.4	A2123147	04-1	IMPELLER NOUМЕНON	1	ETFE	0124X33	P2419051	09	BACK UP RING	1	SUS304	0150X5.5	P2119054
NO	PART NAME	Q'TY	MATERIAL	NOTE	DWG. NO.	04	IMPELLER ASS'Y	1	FKM	019.8X02.4	P20	07-1	INNER MAGNET	1	Sr-FERRITE	076X47	P2449053
						03-4	O. RING	1	FKM	019.8X02.4	P20	07	INNER DRIVE RING	1	ETFE	079.6X71	P2439077
						03-3	SPINDLE	1	CERAMIC	020X65	P2339096	08	INNER DRIVE RING	1	ETFE	079.6X71	P2439077

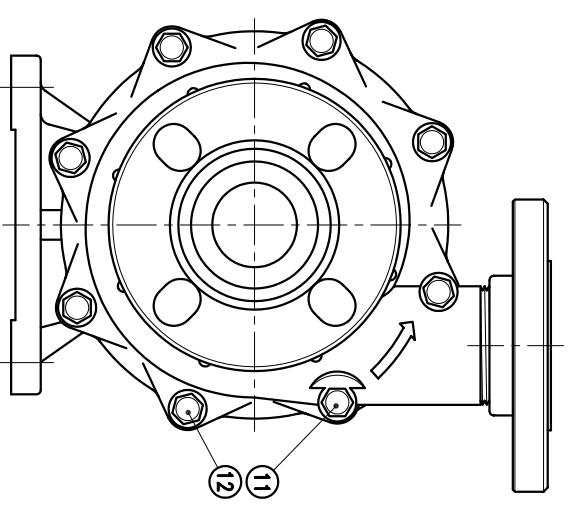
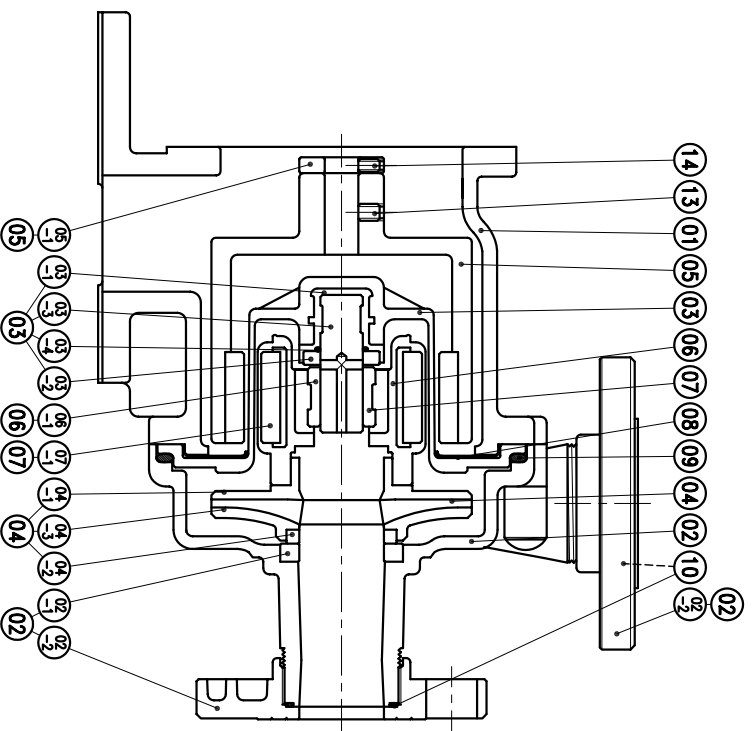

APPROVED	CHECK	04 02 05	MDL NAME	NH-401PW-F(NEMA)
SCALE	DESIGN	10 22 96	DWG. NAME	CONSTRUCTION DRAWING
EDITION	DR.BY	04 02 05 BECKY	DWG. NO.	E2413082
				A3

TPW
HONG YUAN

PAN WORLD CO.,LTD.
PANワールド株式会社