

03-3	SPINDLE	1	SIC	07	INNER DRIVE RING	1	ETFE	079.6X71	P2439077	14	HEXAGON SOCKET BOLT	4	SUS304	3/8" - 16X1" A9119380	
			CERAMIC						P2469100		w/1 S.W.(3/8") (MOTOR)				
03-2	REAR THRUST PAD	1	SIC	06-1	BEARING	1	CERAMIC	032X28	P2469270	13	SET SCREW	1	S435	M6X10 P9116430	
			CERAMIC				ALUM	044X31	P2469076	12	SET SCREW	2	S435	M8X10 P9119160	
03-1	SPINDLE HOLDER	1	ETFE	05-1	RING	1	S45C	057.5X17.5	P2579332	11	HEXAGON HEAD BOLT	5	SUS304	M8X30 P9113079	
			ETFE				ADC-12	0117.5X117	P2509330		w/1 P.W.(017X08.4X11.6)				
03	REAR CASING	1	ETFE	05	OUTER DRIVE RING	1	ADC-12	0117.5X117	P2509330						
			SIC						P2459099	10	HEXAGON HEAD BOLT	1	SUS304	M8X55 P9113079	
02-1	FRONT THRUST PAD	1	CERAMIC	04-3	IMPELLER COVER	1	ETFE	0105X18	P2459099		w/1 P.W.(017X08.4X11.6)				
			ETFE				ROLON	052X7	P2429098						
02	FRONT CASING	1	ETFE	04-2	MOUTH RING	1	ETFE	0105X30	P2419097	09	O. RING	1	FKM	0149.3X05.7 G150	
			FC-20				ETFE		P2409074	08	BACK UP RING	1	SUS304	0140X5.5 P2119089	
01	BRACKET	1	FC-20	04	IMPELLER ASS'Y	1	ETFE	019.8X02.4	P20	07-1	INNER MAGNET	1	FERRITE	076X44.5 P2449101	
NO	PART NAME	Q'TY	MATERIAL	NO	PART NAME	Q'TY	MATERIAL	NOTE	DWG. NO.	NO	PART NAME	Q'TY	MATERIAL	NOTE	DWG. NO.

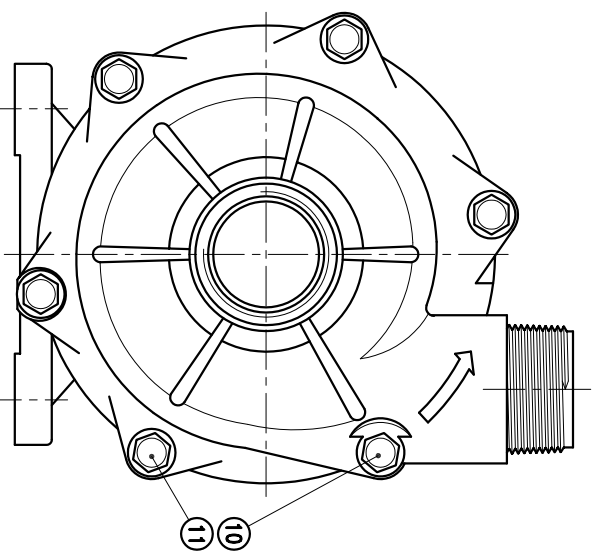
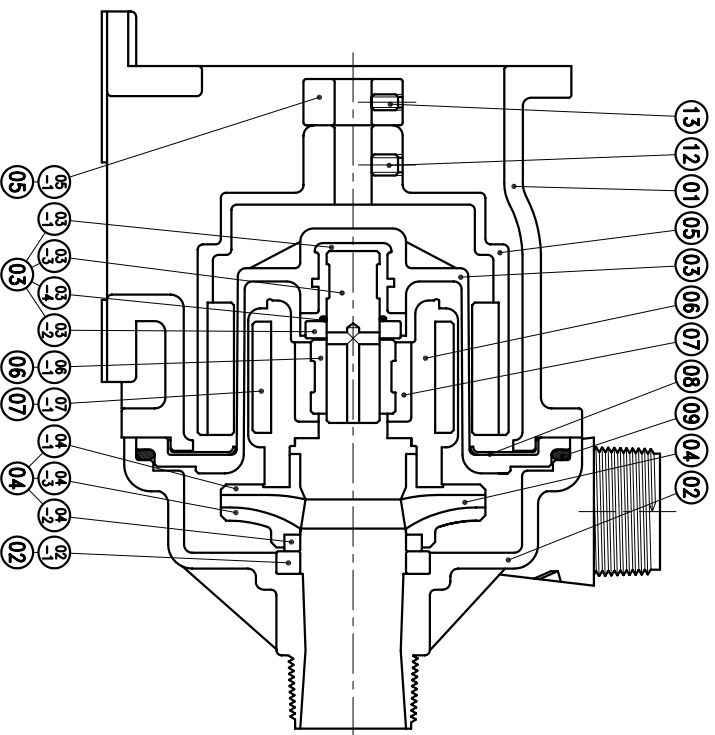

G : 1 1/2" X 1 1/2"  
NPT : 1 1/2" X 1 1/2"

APPROVED		MDL NAME	NH-400PW-F	(NEMA)
CHECK	04.02.05	DWG. NAME	CONSTRUCTION	DRAWING
DESIGN	10.22.96	DWG. NO.	E2403090	A3
DR.BY	04.02.05 BECKY			

TPW  
HONG YUAN

PAN WORLD CO., LTD.  
PANワールド株式会社