

NO	PART NAME	QTY	MATERIAL	NOTE	PART NO.
01-3	COVER C	1	FC-20	φ153X45	
01-2	COVER B	1	FC-20	φ127X23	100571800
01-1	COVER A	1	FC-20	φ210X59.5	
01	BRACKET	1	FC-20	φ210X186.5	1004519104

NO	PART NAME	QTY	MATERIAL	NOTE	PART NO.
08	REAR CASING COVER	1	SUS304	φ164X137	1004912308
07	INNER DRIVE RING	1	ETFE	φ79.6X124	
06	BEARING ASS'Y	1	SIC		1004711300
			CERAMIC RULON CARBON	φ44X46.5	1004710803 1004710802 1004711200
05-1	RING	1	S45C	φ48X9.8	
05	OUTER DRIVE RING	1	FCD-45	φ118X183.5	1003511800
04	IMPELLER ASS'Y	1	ETFE		1004911514
03	REAR CASING	1	ETFE		1004710201
02	FRONT CASING	1	CERAMIC		1004710200
			SIC	φ228.6X38.5	1005711390
01-4	TRANSITION FLANGE	1	FC-20	φ228.6X38.5	1005711300

NO	PART NAME	QTY	MATERIAL	NOTE	PART NO.
19	HEXAGON SOCKET BOLT w/1 SPRING WASHER	4	SUS304	1/2"-13X1"	
18	HEXAGON SOCKET BOLT	4	S435	M10X35	
17	SET SCREW	2	S435	M6X10	
16	SET SCREW	2	S435	M8X10	
15	HEXAGON SOCKET BOLT	3	SUS304	M6X20	
14	HEXAGON SOCKET BOLT	2	SUS304	M6X16	
13	HEXAGON SOCKET BOLT	4	SUS304	M8X16	
12	HEXAGON SOCKET BOLT w/1 SPRING WASHER	7	SUS304	M8X40	
11	HEXAGON SOCKET BOLT w/1 SPRING WASHER	1	SUS304	M8X60	
10	O. RING	1	FKM	G175	1004711500
09-2	PTFE BOARD	1	PTFE	281.8X122.9	
09-1	PTFE BOARD	1	PTFE	278.6X122.9	
09	PTFE BOARD	2	PTFE	L X 122.9	

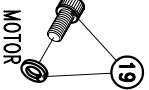
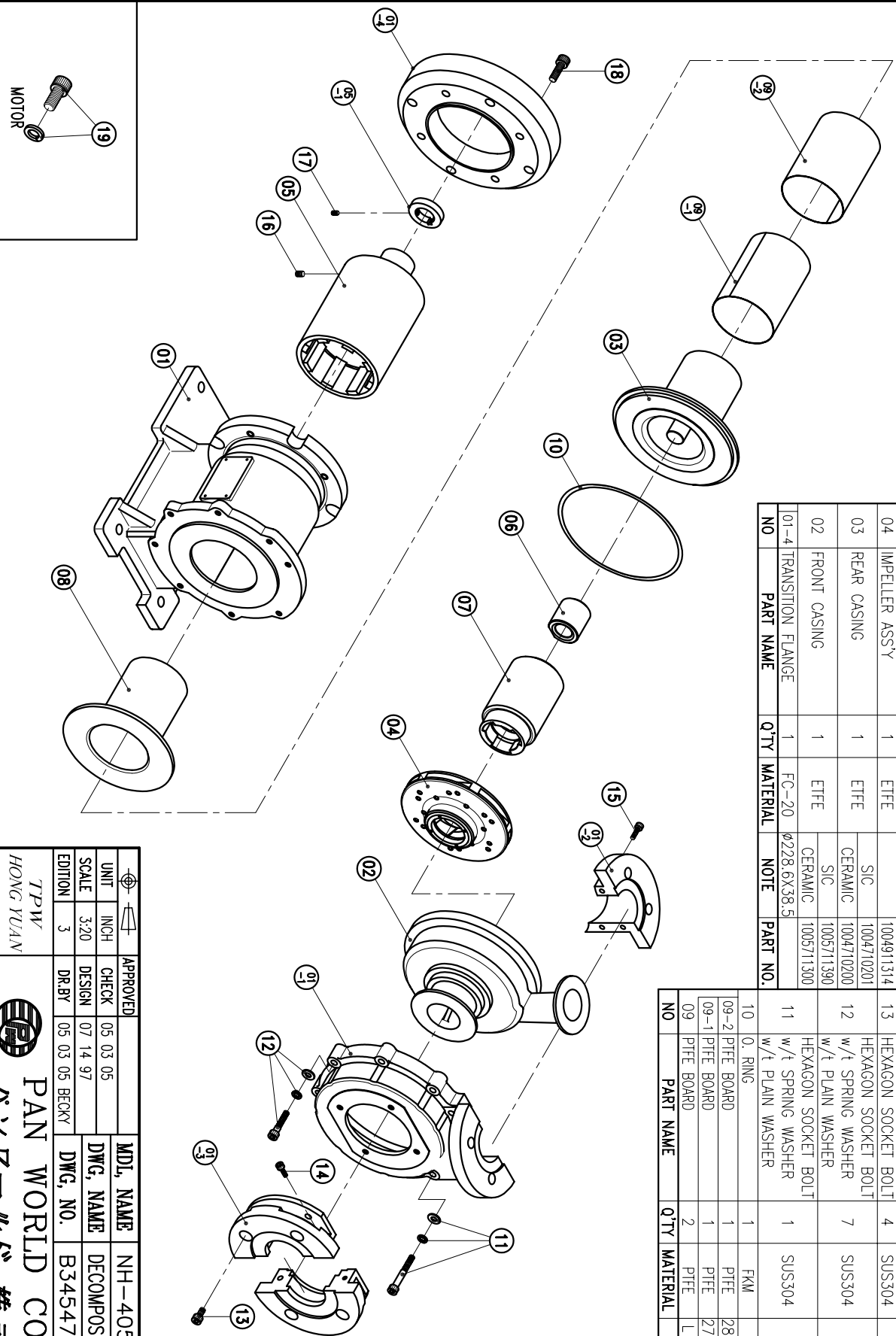

MOTOR

APPROVED	CHECK	SCALE	EDITION	MDL. NAME	DWG. NAME	DWG. NO.	DR. BY
	05 03 05	3:20	3	NH-405PW-C (NEMA)	DECOMPOSITION DRAWING	B3454735	TPW HONG YUAN

PAN WORLD CO., LTD.  
 パンワールド 株式会社