

04	IMPELLER ASS'Y	1	ETFE	P2409029	09	PTFE BOARD	2	PTFE	L X 122.9 A2119713	19	HEXAGON SOCKET BOLT	4	SUS304	1/2" - 13X1"
03-4	O. RING	1	FKM	φ24.4Xφ3.1	G25	08-3 COVER	1	SUS304	φ90.4X12 A2119715	18	HEXAGON SOCKET BOLT	4	SUS304	w/t S.W.(1/2")(MOTOR)
03-3	SPINDLE	1	SIC	φ25X125	P2339005	08-2 PIPE	1	HASTELLOY C	φ90.4X127.5A2119716	17	SET SCREW	2	S435	M10X35 P9119154
03-2	REAR THRUST PAD	1	SIC	φ37X8	P2329188	08-1 BACK UP RING	1	SUS304	φ164X5.5 A2119714	16	SET SCREW	2	S435	M8X10 P9116430
03-1	SPINDLE HOLDER	1	CERAMIC	φ41X131	P2329184	07-1 INNER MAGNET	1	Nd-Fe-B	φ76X9.3 P2449491	15	HEXAGON SOCKET BOLT	3	SUS304	M6X20 P9119156
03	REAR CASING	1	ETFE	φ186.5X140	P2309737	07 INNER DRIVE RING	1	ETFE	φ79.6X124 P2439018	14	HEXAGON SOCKET BOLT	2	SUS304	M6X16 P9119156
02-1	FRONT THRUST PAD	1	SIC	φ72X9	P2229315	06-1 BEARING	1	CERAMIC CARBON RULON	φ36X45	13	HEXAGON SOCKET BOLT	4	SUS304	M8X16 P9119155
02	FRONT CASING	1	ETFE	φ198X107	P2204164	06 BEARING ASS'Y	1	ETFE	φ44X46.5 A2469553	12	HEXAGON SOCKET BOLT	7	SUS304	M8X40 P9119155
01-4	TRANSITION FLANGE	1	FC-20	φ228.6X36.5	P2174306	05-1 RING	1	S45C	φ48X9.8 P2579342	11	HEXAGON SOCKET BOLT	1	SUS304	φ174.3Xφ5.7 G175
01-3	COVER C	1	FC-20	φ153X45	A2154032	05 OUTER DRIVE RING	1	FCD-45	φ122X205 P2509341	10	O. RING	1	FKM	φ174.3Xφ5.7 G175
01-2	COVER B	1	FC-20	φ127X23	A2144035	04-3 IMPELLER COVER	1	ETFE	φ160X25 P2459026	09-2	PTFE BOARD	1	PTFE	φ281.8X122.9A2119713
01-1	COVER A	1	FC-20	φ210X59.5	A2134034	04-2 MOUTH RING	1	RULON	φ63X8 P2429006	09-1	PTFE BOARD	1	PTFE	φ278.6X122.9A2119713
01	BRACKET	1	FC-20	φ210X186.5	P2124979	04-1 IMPELLER NOUWENON	1	ETFE	φ160X44 P2419024	10	O. RING	1	FKM	φ174.3Xφ5.7 G175

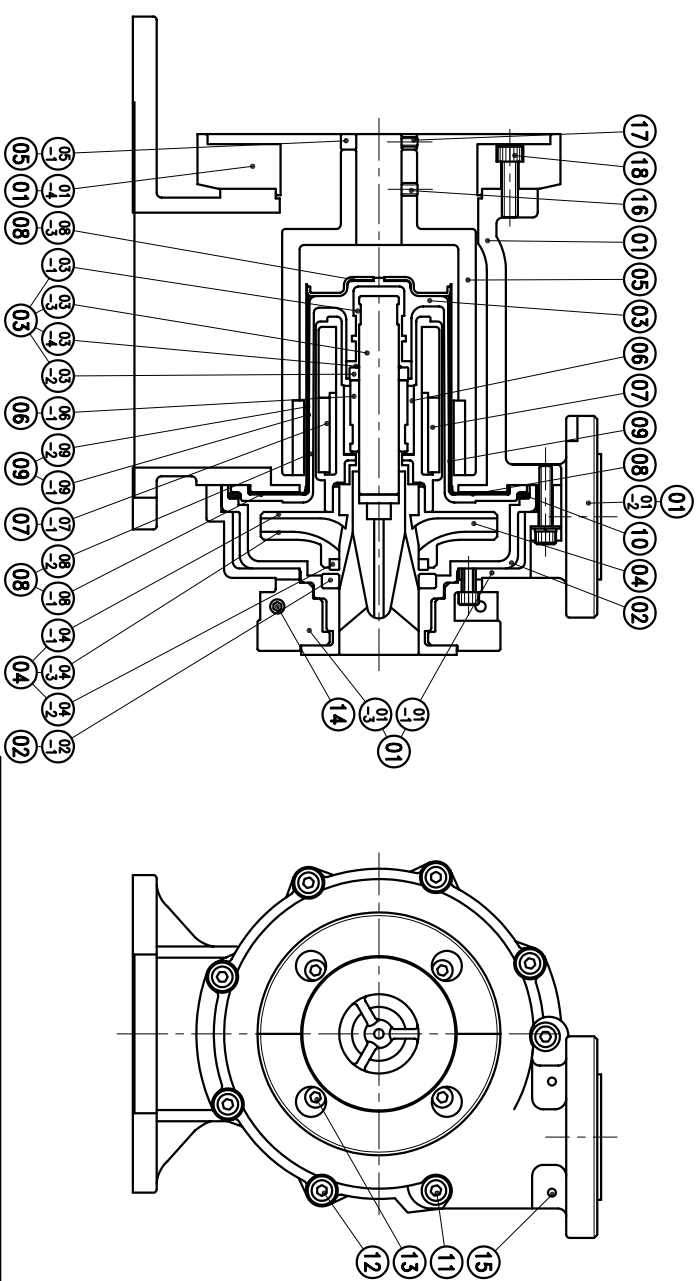

APPROVED	MDL. NAME	NH-405PW-C (NEMA)
CHECK	DWG. NAME	CONSTRUCTION DRAWING
DESIGN	DWG. NO.	B2454681
DRBY		A3
EDITION		

TPW  
HONG YUAN

PAN WORLD CO., LTD.  
パンワールド株式会社