

NO	PART NAME	QTY	MATERIAL	NOTE	PART NO.
02	FRONT CASING	1	PPG	HOSE THREAD	1001006100
01	MOTOR	1	250W-2P	100~120V 200~240V	1001098200 1001090100
10	SET SCREW	2	S435		
09	HEXAGON HEAD BOLT w/t PLAIN WASHER	6	SUS304	M6X55	
08	O. RING	1	FKM	G110	1001001300
07	BACK UP RING	1	SUS304	φ98X4.5	1001008600
06	BEARING	1	CERAMIC CARBON	φ25X35	
05	OUTER DRIVE RING	1	ADC-12 RULON		1001000900
04	IMPELLER ASS'Y	1	PPG	φ86X86	1003411800
03	REAR CASING	1	PPS	φ123X75	1001000500

NO	PART NAME	QTY	MATERIAL	NOTE	PART NO.
10	SET SCREW	2	S435	M6X10	
09	HEXAGON HEAD BOLT w/t PLAIN WASHER	6	SUS304	M6X55	
08	O. RING	1	FKM	G110	1001001300
07	BACK UP RING	1	SUS304	φ98X4.5	1001008600
06	BEARING	1	CERAMIC CARBON	φ25X35	
05	OUTER DRIVE RING	1	ADC-12 RULON		1001000900
04	IMPELLER ASS'Y	1	PPG	φ86X86	1003411800
03	REAR CASING	1	PPS	φ123X75	1001000500

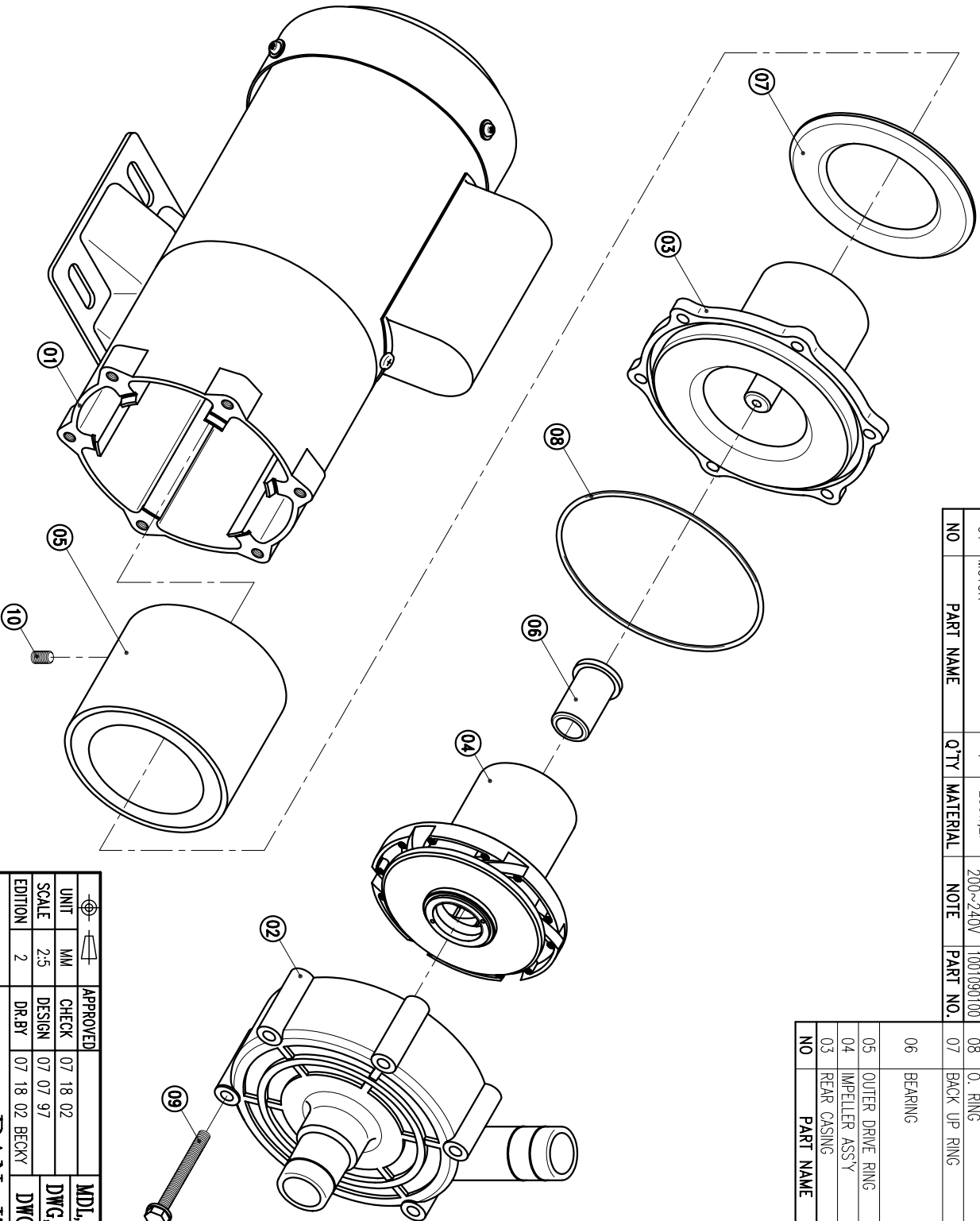

HOSE: 26mm X 26mm  
 G : 1" X 1"  
 NPT : 1" X 1"

APPROVED	CHECK	DATE	MDL NAME	NH-250PS
	07 18 02		DWG, NAME	DECOMPOSITION DRAWING
	07 07 97		DWG, NO.	B3252349
	07 18 02	BECKY		A3

TPW  
HONG YUAN



PAN WORLD CO., LTD.  
 パンワールド株式会社