

03-3	SPINDLE	1	CERAMIC	φ20X65	P2339096	06	BEARING ASSY	1	ETFE	φ44X31	P2469076	11	SET SCREW	2	S435	M8X10	P9119160
03-2	REAR THRUST PAD	1	CERAMIC	φ36X6.5	P2329095	05	OUTER DRIVE RING	1	ADC-12	φ117.5X119	P2509075	10	HEXAGON HEAD BOLT w/t P.W.(φ15.5Xφ8.4X11)	6	SUS304	M8X50	P9113079
03-1	SPINDLE HOLDER	1	PPG	φ40X68	P2379093	04-3	IMPELLER COVER	1	PPG	φ100X20	P2452117	09	O. RING	1	FKM	φ129.4Xφ3.1	G130
03	REAR CASING	1	PPG	φ149X33.5	A2302259	04-2	MOUTH RING	1	RULON	φ34X5	P2422112	08	BACK UP RING	1	SUS304	φ130X6	A2112260
02-1	FRONT THRUST PAD	1	CERAMIC	φ40X7	P2222106	04-1	IMPELLER NOUМЕНON	1	PPG	φ120X22	A2412257	07-1	INNER MAGNET	1	FEFRIE	φ76X44.5	P2449101
02	FRONT CASING	1	PPG	φ149X68	A2202258	04	IMPELLER ASSY	1	PPG		A2402307	07	INNER DRIVE RING	1	PPG	φ79.6X71	P2439077
01	MOTOR	1	350W , 2P 3φ 200/400V/220/380V			03-4	O. RING	1	FKM	φ19.8Xφ2.4	P20	06-1	BEARING	1	CERAMIC CARBON RULON	φ32X28	P2469770 P2469771 A2469347

NO	PART NAME	Q'TY	MATERIAL	NOTE	DWG. NO.
06-1	BEARING	1	CERAMIC CARBON RULON	φ32X28	P2469770 P2469771 A2469347

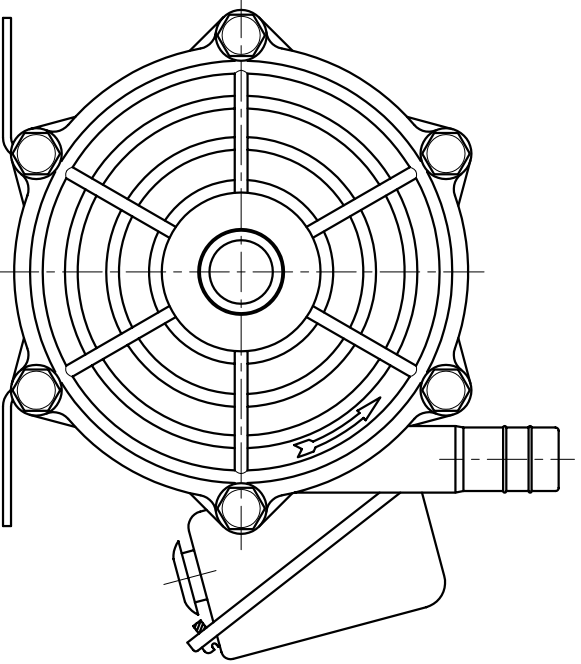
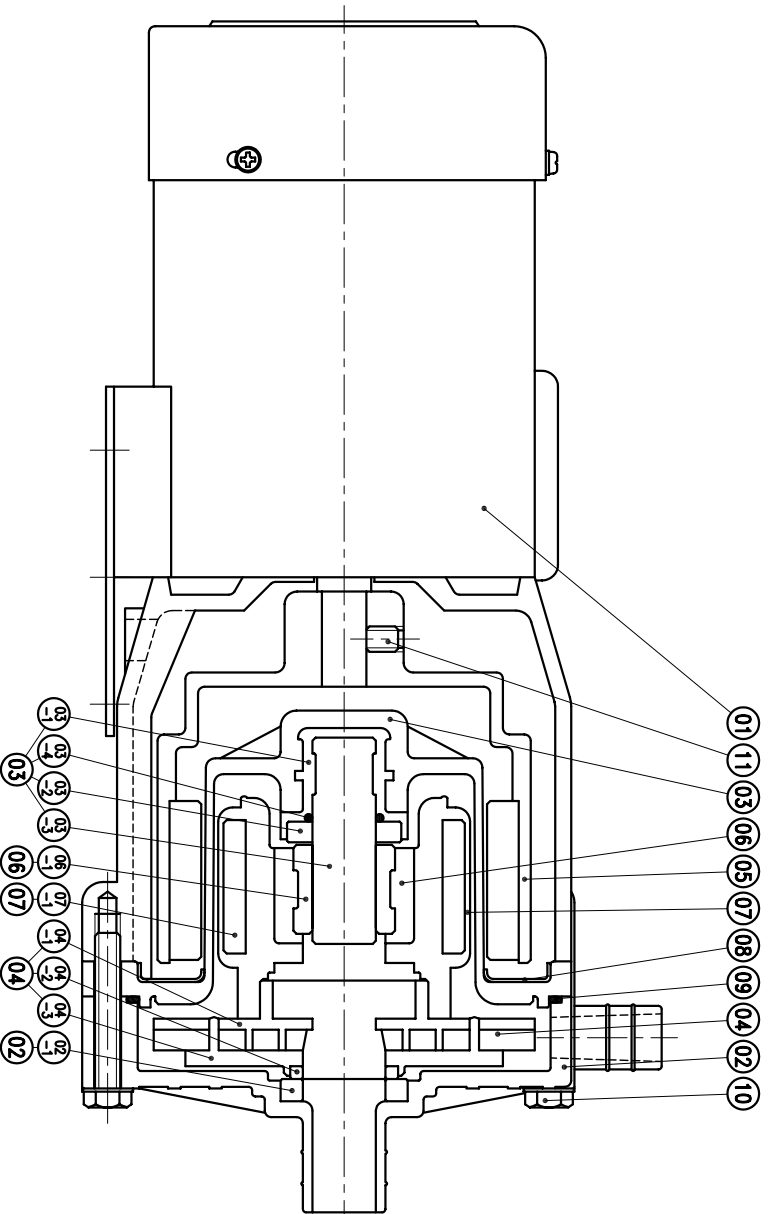

G : 3/4"X 1"  
NPT : 3/4"X 1"

APPROVED	CHECK	08 21 02	MDL NAME	NH-300PS-3
CHECK	DESIGN	08 21 02	DWG. NAME	CONSTRUCTION DRAWING
DR.BY	08 21 02 BECKY		DWG. NO.	B2302955
EDITION	1			A3

TPW  
HONG YUAN



PAN WORLD CO.,LTD.  
パナワールド株式会社