

NO	PART NAME	Q'TY	MATERIAL	NOTE	DWG. NO.
03-3	SPINDLE	1	CERAMIC	φ20X65	P2339096
03-2	REAR THRUST PAD	1	CERAMIC	φ36X6.5	P2329095
03-1	SPINDLE HOLDER	1	PPG	φ40X68	P2379093
03	REAR CASING	1	PPG	φ149X33.5	A2302259
02-1	FRONT THRUST PAD	1	CERAMIC	φ40X7	P2222106
02	FRONT CASING	1	PPG	φ149X68	A2202258
01	MOTOR	1	350W , 2P 100~120V,200~240V		

NO	PART NAME	Q'TY	MATERIAL	NOTE	DWG. NO.
06	BEARING ASSY	1			
05	OUTER DRIVE RING	1	ADC-12	φ117.5X119	P2509075
04-3	IMPELLER COVER	1	PPG	φ100X20	P2452117
04-2	MOUTH RING	1	RULON	φ34X5	P2422112
04-1	IMPELLER NOUUMENON	1	PPG	φ120X22	A2412257
04	IMPELLER ASSY	1	PPG		A2402307
03-4	O. RING	1	FKM	φ19.8Xφ2.4	P20
11	SET SCREW	2	S435	M8X10	P9119160
10	HEXAGON HEAD BOLT w/t P.W.(φ15.5Xφ8.4X11)	6	SUS304	M8X50	P9113079
09	O. RING	1	FKM	φ129.4Xφ3.1	G130
08	BACK UP RING	1	SUS304	φ130X6	A2112260
07-1	INNER MAGNET	1	FEFRIE	φ76X44.5	P2449101
07	INNER DRIVE RING	1	PPG	φ79.6X71	P2439077
06-1	BEARING	1	CERAMIC CARBON RULON	φ32X28	P2469770 P2469771 A2469347

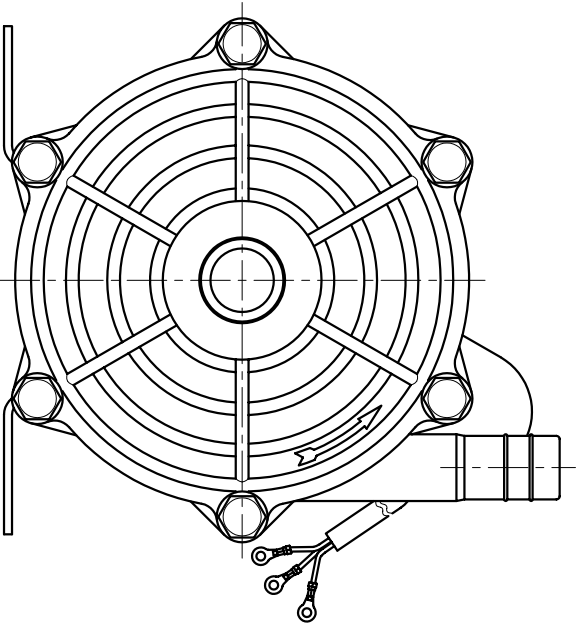
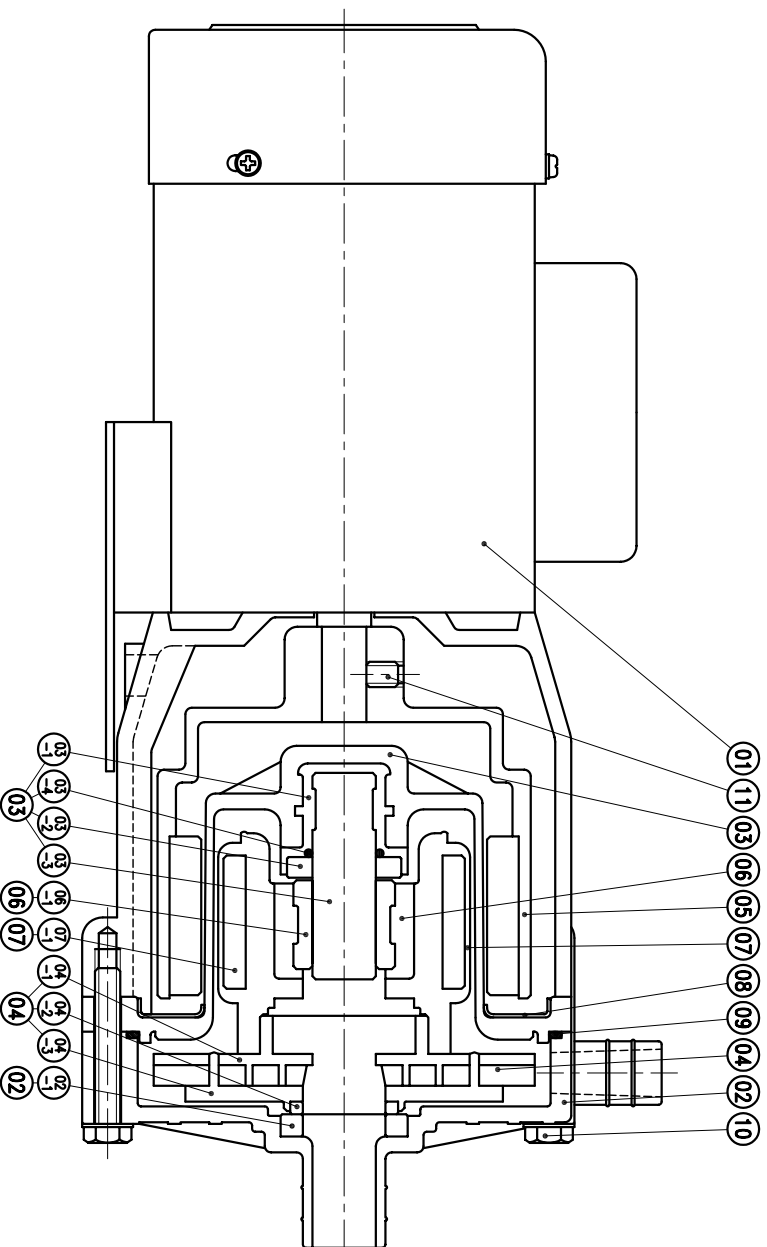

G : 3/4"X 1"  
NPT : 3/4"X 1"

APPROVED	CHECK	MDL. NAME	NH-300PS
08 21 02	08 21 02	DWG. NAME	CONSTRUCTION DRAWING
03 31 01	03 31 01	DWG. NO.	B2302768
08 21 02 BECKY	08 21 02 BECKY		A3

TPW  
HONG YUAN



PAN WORLD CO., LTD.  
パンワールド株式会社