

NO	PART NAME	Q'TY	MATERIAL	NOTE	PART NO.
02	FRONT CASING	1	ETFE CERAMIC	HOSE THREAD HOSE 1002525190 1002525100	
01	MOTOR	1	150W,2P	200~240V 1001098100 1001003100	

10	SET SCREW	2	S435	M6X10	
09	HEXAGON HEAD BOLT w/PLAIN WASHER	6	SUS304	M6X55	
08	O. RING	1	FKM	G110	1002521100
07	BACK UP RING	1	SUS304	φ98X4.5	1001008600
			SIC		1031000900
06	BEARING	1	CERAMIC CARBON RULON	φ25X35	
05	OUTER DRIVE RING	1	ADC-12	φ86X86	1003411800
04	IMPELLER ASS'Y	1	ETFE		
03	REAR CASING	1	ETFE		
			SIC		1010000900
			CERAMIC		1040000900

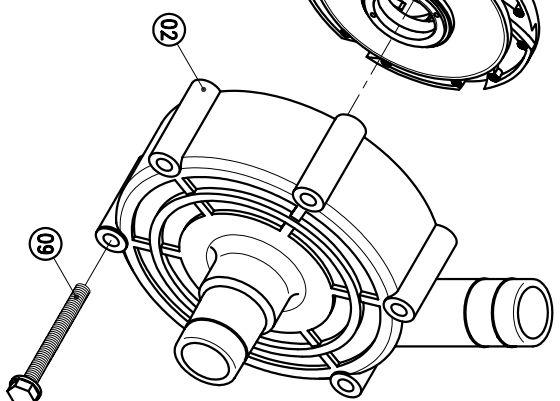
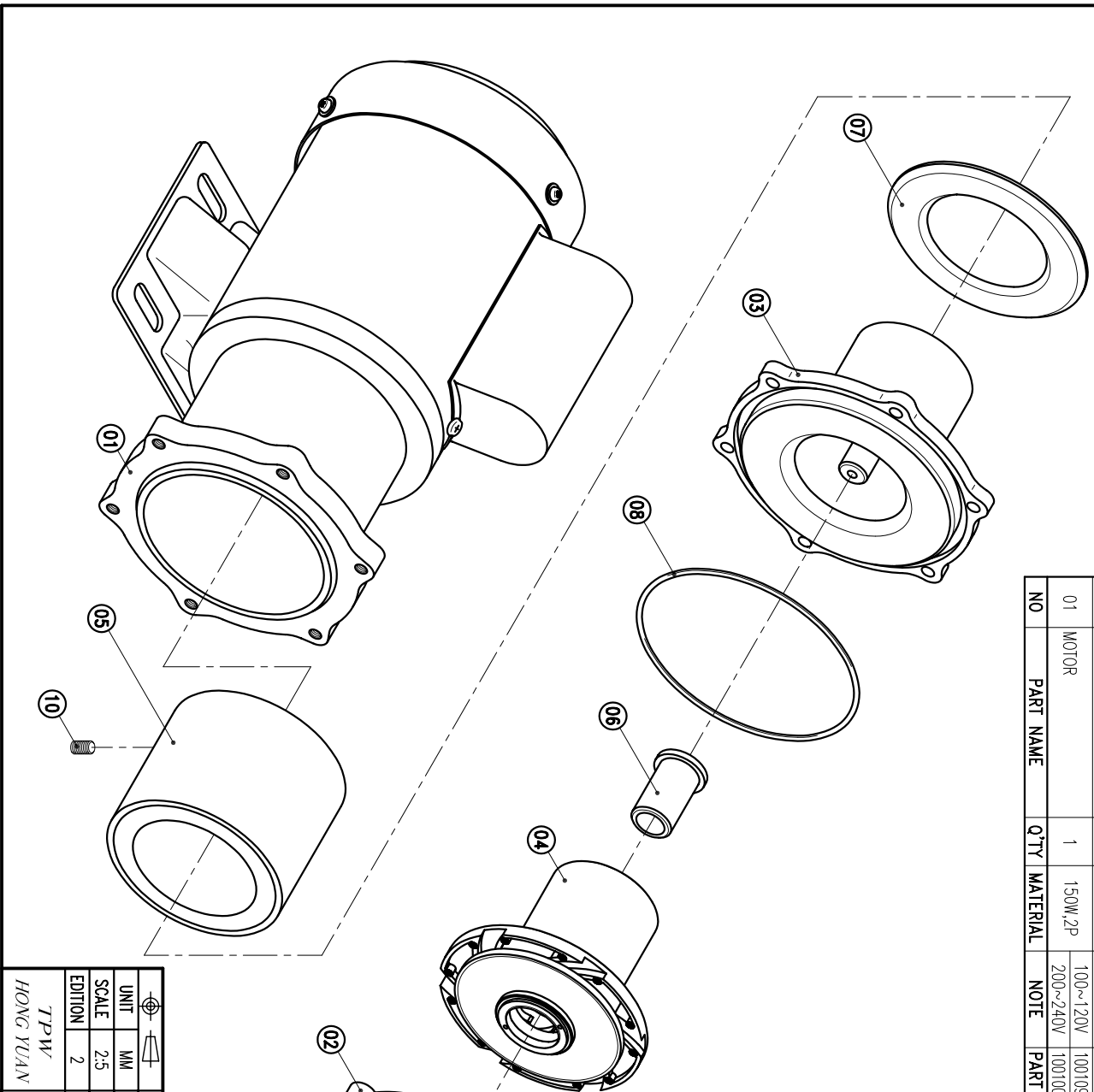

HOSE: 26mm X 26mm  
G : 1" X 1"  
NPT : 1" X 1"

UNIT	MM	CHECK	07 18 02	MDL NAME	NH-200PS-Z-F
SCALE	2.5	DESIGN	03 15 02	DWG. NAME	DECOMPOSITION DRAWING
EDITION	2	DR.BY	07 18 02 BECKY	DWG. NO.	B3202146
					A3

TPW  
HONG YUAN



PAN WORLD CO., LTD.  
パンワールド株式会社