

03-2	REAR THRUST PAD	1	CERAMIC	φ23X4	P2322109	05	OUTER DRIVE RING	1	CERAMIC	φ68X86	P2509064	10	SET SCREW	2	S435	M6X10	P9116430
03-1	SPINDLE HOLDER	1	ETFE	φ25X64	A2372356	04-4	IMPELLER COVER	1	ETFE	φ100X20	P2452117	09	HEXAGON HEAD BOLT w/L P.W.(φ11.5Xφ6.4X1.6)	6	SUS304	M6X55	P9119009
03	REAR CASING	1	ETFE	φ123.5X74	P2302062	04-3	INNER MAGNET	1	FERRITE	φ50X50	P2442113	08	O. RING	1	FKM	φ109.4Xφ3.1	G110
02-1	FRONT THRUST PAD	1	CERAMIC	φ40X7	P2222106	04-2	MOUTH RING	1	RUOLON	φ34X5	P2422112	07	BACK UP RING	1	SUS304	φ98X4.5	P2112067
02	FRONT CASING	1	ETFE	φ123.5X87.5	P2202061	04-1	IMPELLER VANE	1	ETFE	φ100X76.5	P2412111	06	BEARING	1	SUS304	φ25X35	P210657
01	MOTOR	1	150W, 2P 100~120V, 200~240V			03-4	O. RING	1	TEFLON	φ13.8Xφ2.4	P14	05-2	OUTER MAGNET	1	FERRITE	φ80X50	P2522116
						03-3	SPINDLE	1	CERAMIC	φ14X60	P2332110	05-1	MAGNET HOUSING	1	ADC-12	φ86X86	P2512114

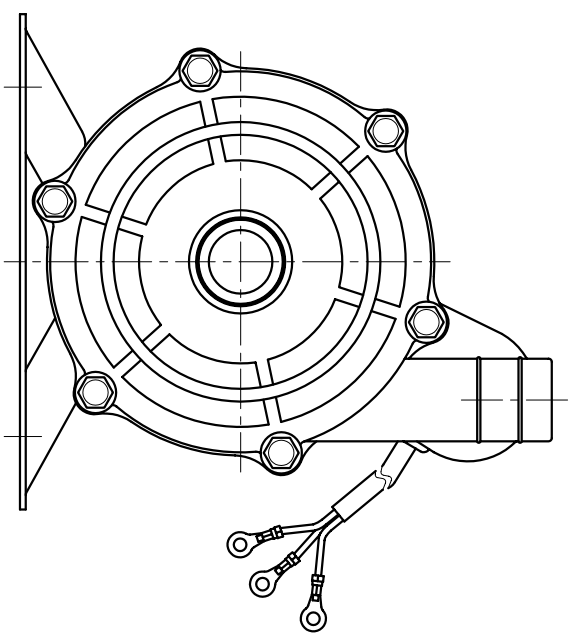
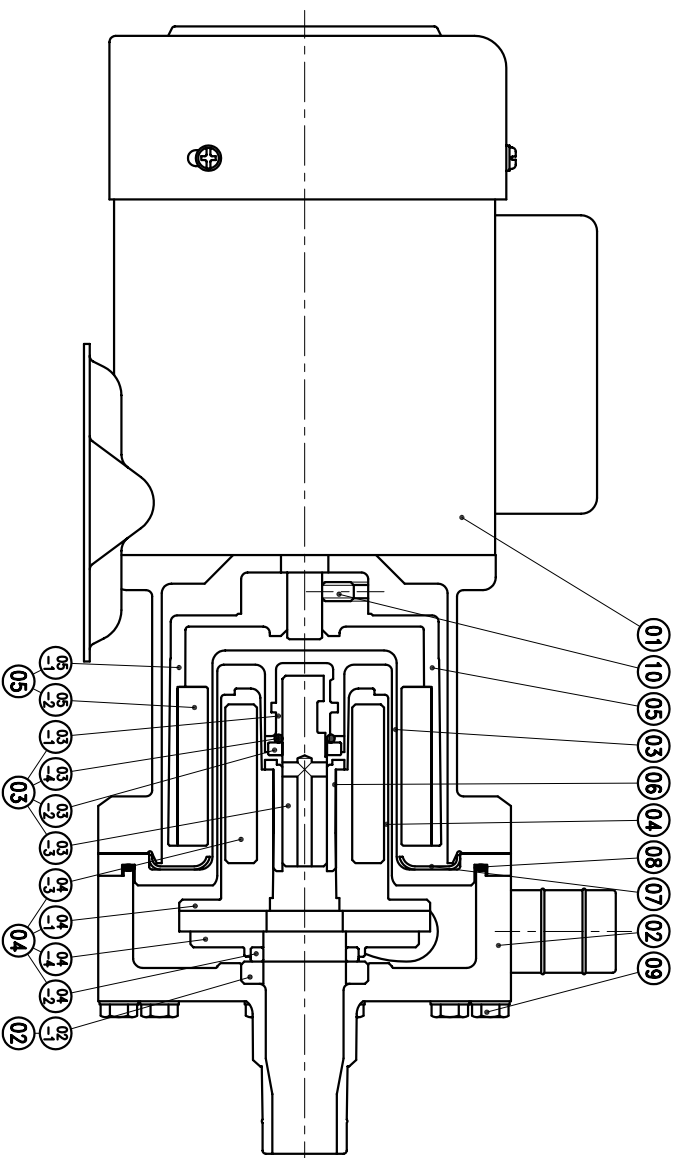

G : 1"X 1"
NPT : 1"X 1"

APPROVED	MDL NAME	NH-200PS-F
CHECK	DWG. NAME	CONSTRUCTION DRAWING
DESIGN	DWG. NO.	B2202459
DR.BY		A3
EDITION		
2		

TPW
HONG YUAN



PAN WORLD CO., LTD.
パンワールド株式会社