

NO	PART NAME	QTY	MATERIAL	NOTE	PART NO.	NO	PART NAME	QTY	MATERIAL	NOTE	PART NO.
06	FRIST CASING	1	PPS	φ143X32.5	1007010421	16	O. RING	1	FKM	G30	1007012701
05-1	RING	1	S45C	2.2 kW		15	O. RING	1	FKM	G130	1007012700
05	OUTER DRIVE RING	1	FCD-45	2.2 kW	1007010720	14	CHAMBER GASKET	9	FKM	φ129.4Xφ3.1	1007010300
04	IMPELLER ASS'Y	9	PPS		1007010410	13	BACK UP RING	1	SPCC	φ139X4	1007010300
03	REAR CASING ASS'Y	1	PPS	φ139X93.3	1007010203	12	INNER DRIVE RING	1	Nd-Fe-B	2.2 kW	1007112353
02	FRONT CASING	1	PPS	210X48	1007012303	11	CLUTCH	1	PPS	φ58X12.5	1007010400
01-3	TRANSITION FLANGE	1	FC-20	2.2 kW		10	FRONT THRUST BEARING	1	PPS	φ36X18	1003010811
01-2	OUTER CASING COVER	1	SUS304	φ145.2X262	1007010984	09	BEARING ASS'Y	1	ETFE	φ44X31	1003010812
01-1	BASE PLATE	1	FC-20	170X160X7.5	1007010600	08	LAST CASING	1	PPS	φ143X40	1007010422
01	BRACKET	1	ADC-12	2.2 kW	1007010502	07	MID CASING	7	PPS	φ143X40	1007010420
						23	HEXAGON SOCKET BOLT	4	SUS304	3/8"-16X1"	
						22	w/t S.W.(3/8")(MOTOR)	4	SUS304	M10	
						21	NUT	4	SUS304	M10	
						20	COUNTER SUNK HEAD BOLT	4	S435	M8X25	
						19	STUD BLOT	4	SUS304	M10X320	1007010960
						18	w/t P.W. + S.W. (M10)	2	S45C	M6X10	
						17	SET SCREW	2	S45C	M8X10	
						16	SET SCREW	2	S45C	M8X10	
						15	EXHAUST VALVE	1			

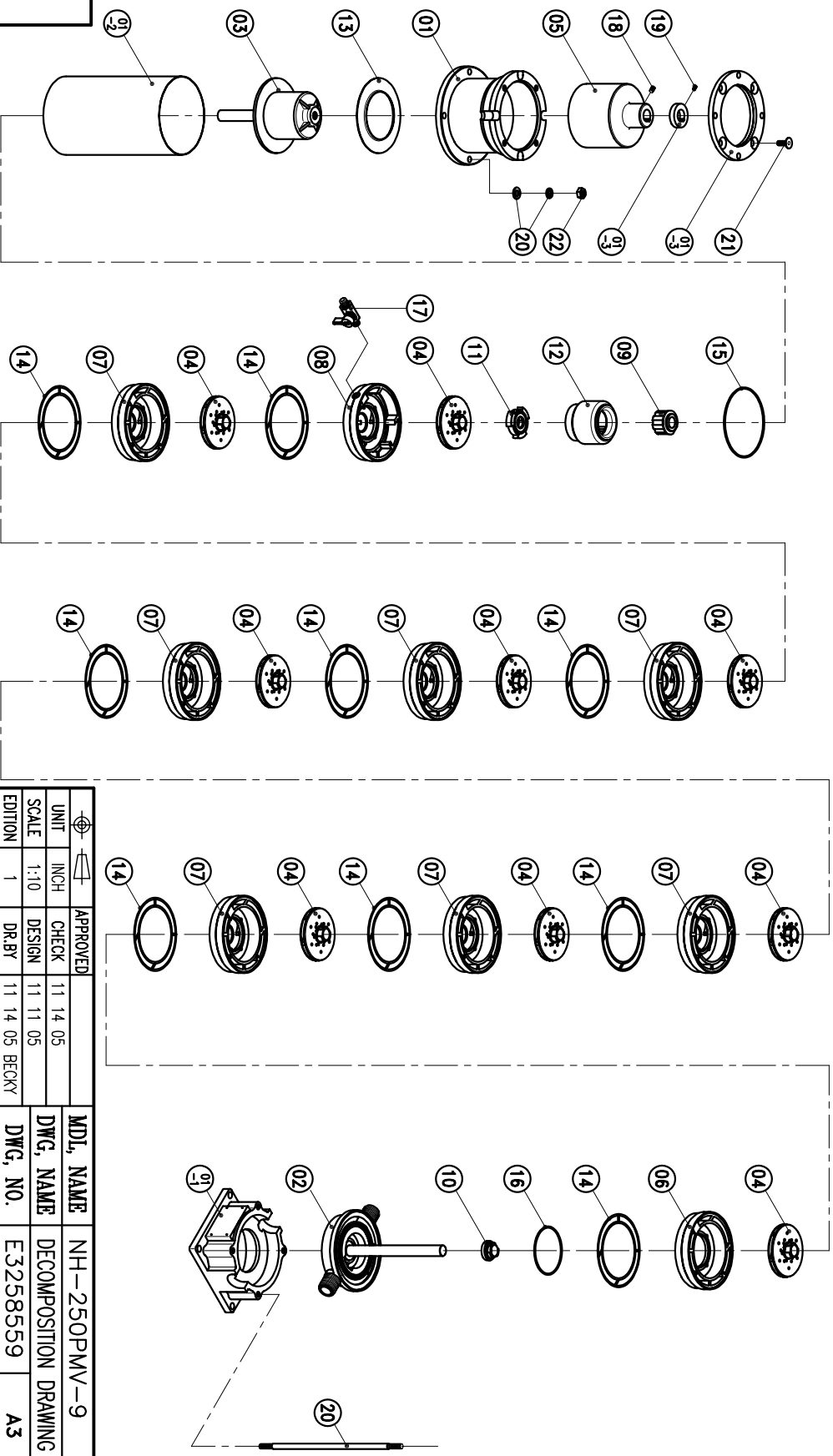

MOTOR FLANGE

APPROVED	CHECK	DESIGN	DR.BY	MDL. NAME	DWG. NAME	DWG. NO.
11 14 05	11 11 05	11 11 05	11 14 05	NH-250PMV-9	DECOMPOSITION DRAWING	E3258559
UNIT	SCALE	EDITION				
INCH	1:10	1				A3

TPW
HONG YUAN



PAN WORLD CO., LTD.
パンワールド株式会社