

NO	PART NAME	Q'TY	MATERIAL	NOTE	PART NO.
05-1	RING	1	S45C	2.2 kW 1.5 kW 0.75 kW	
05	OUTER DRIVE RING	1	FOD-45	2.2 kW 1.5 kW	1007010720
04	IMPELLER ASS'Y	4	ETFE	0.75 kW	1003111800
03	REAR CASING ASS'Y	1	ETFE		1007010410
02	FRONT CASING	1	ETFE	$\phi 139 \times 93.3$ 210X48	1007010200
01-2	TRANSITION FLANGE	1	FC-20	2.2 kW 1.5 kW 0.75 kW	
01-1	BASE PLATE	1	FC-20		170X160X75 1007010630
01	BRACKET	1	ADC-12	2.2 kW 1.5 kW 0.75 kW	1007010502 1007010501
14	CHAMBER GASKET	4	FKM	$\phi 129.4 \times \phi 3.1$	
13	BACK UP RING	1	SPCC	$\phi 139 \times 4$	1007010300
12	INNER DRIVE RING	1	Nd-Fe-B	2.2 kW 1.5 kW	1007112352
11	CLUTCH	1	Sr-FERRITE	0.75 kW	1003912371
10	FRONT THRUST BEARING	1	ETFE	$\phi 58 \times 12.5$	1007010400
09	BEARING ASS'Y	1	ETFE	$\phi 36 \times 18$	1003010811
08	LAST CASING	1	ETFE	$\phi 44 \times 31$	1003010812
07	MID CASING	2	ETFE	$\phi 143 \times 40$	1007010420
06	FRST CASING	1	ETFE	$\phi 143 \times 32.5$	1007010421
23	HEXAGON SOCKET BOLT	4	SUS304	$3/8" - 16 \times 1"$	
22	W/t S.W.(3/8")(MOTOR)	4	SUS304	M10	
21	NUT	4	SUS304	M10	
20	COUNTER SUNK HEAD BOLT	4	S435	M8X25	
19	STUD BLOT	4	SUS304	M10X175	1007010910
18	W/t P.W. + S.W. (M10)	2	S45C	M6X10	
17	SET SCREW	2	S45C	M8X10	
16	SET SCREW	2	S45C	M8X10	
15	EXHAUST VALVE	1	FKM	G90	1007012701
14	O. RING	1	FKM	G130	1007012700
13	O. RING	1	FKM	G130	1007012700

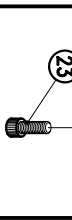
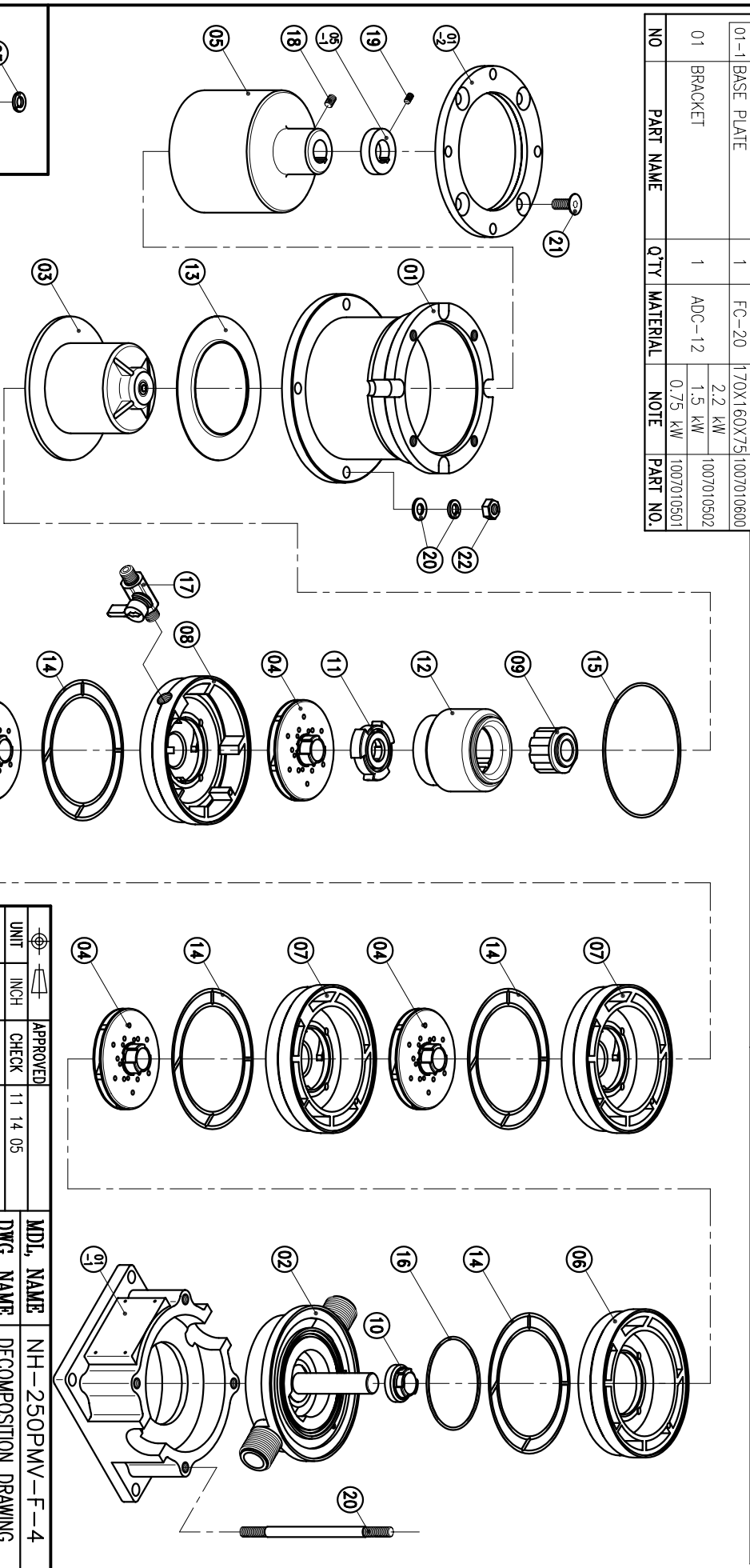

MOTOR FLANGE

UNIT	INCH	CHECK	11 14 05	MDL NAME	NH-250PMV-F-4
SCALE	1:5	DESIGN	11 14 05	DWG. NAME	DECOMPOSITION DRAWING
EDITION	1	DR.BY	11 14 05	DWG. NO.	E3258590
				APPROVED	A3

TPW
HONG YUAN

PAN WORLD CO., LTD.
パンワールド株式会社