

04-1	IMPELLER	1	PPS	φ170X41	A2418462	08	REAR CASING COVER	1	08-1,-2,-3	φ158X121	A2118477	14	HEXAGON SOCKET BOLT	4	SUS304	1/2"-13X1 1/4"	
04	IMPELLER ASS'Y	1	PPS	5012PH	A2408581	07	SPINDLE	1	CERAMIC	φ38X156	A2338480	13	HEXAGON SOCKET BOLT	4	SUS304	M8X60	
				5013PH			SIC										
03-1	BEARING	1	CARBON	φ40X25	A2228423	06-2	DRIVEN MAGNET	1	Nd-Fe-B	φ76X86	A2448506	12	EBEBOLT	1	S41C	M12X20	
03	REAR CASING	1	PPS	φ210X123.5	A2308476	06-1	REAR THRUST PAD	1	CERAMIC	φ48X10	A2338512	11	SET SCREW	2	S435	M8X10	
				SIC			SIC										
02-2	BEARING	1	CARBON	φ40X25	A2228423	06	MAGNET CAPSULE	1	PPG	φ79.6/69.5	A2438472	10	HEXAGON HEAD BOLT	8	SUS304	M10X80	
02-1	FRONT THRUST PAD	1	CERAMIC	φ104X9	P2224475	05-1	FLY WHEEL	1	S45C	φ122X68	A2538511	09	O. RING	1	FKM	φ199.3Xφ5.7	
						SIC			FCD-45	φ122X199	A2508564						G200
02	FRONT CASING	1	PPS	φ226.5X118.5	A2208546	04-3	SHLOUD	1	PPS	φ170X12	A2458481	08-3	COVER	1	SUS304	φ90.2X17.5	
01	BRACKET	1	FC-20	φ226.5X184.5	A2128563	04-2	MOUTH RING	1	RULON	φ104X9	A2428549	08-2	PIPE	1	HASTELLOY C	φ91.4X112	
												08-1	BACK UP RING	1	SUS304	φ158X4	
NO	PART NAME	Q'TY	MATERIAL	NOTE	DWG. NO.	NO	PART NAME	Q'TY	MATERIAL	NOTE	DWG. NO.	NO	PART NAME	Q'TY	MATERIAL	NOTE	DWG. NO.

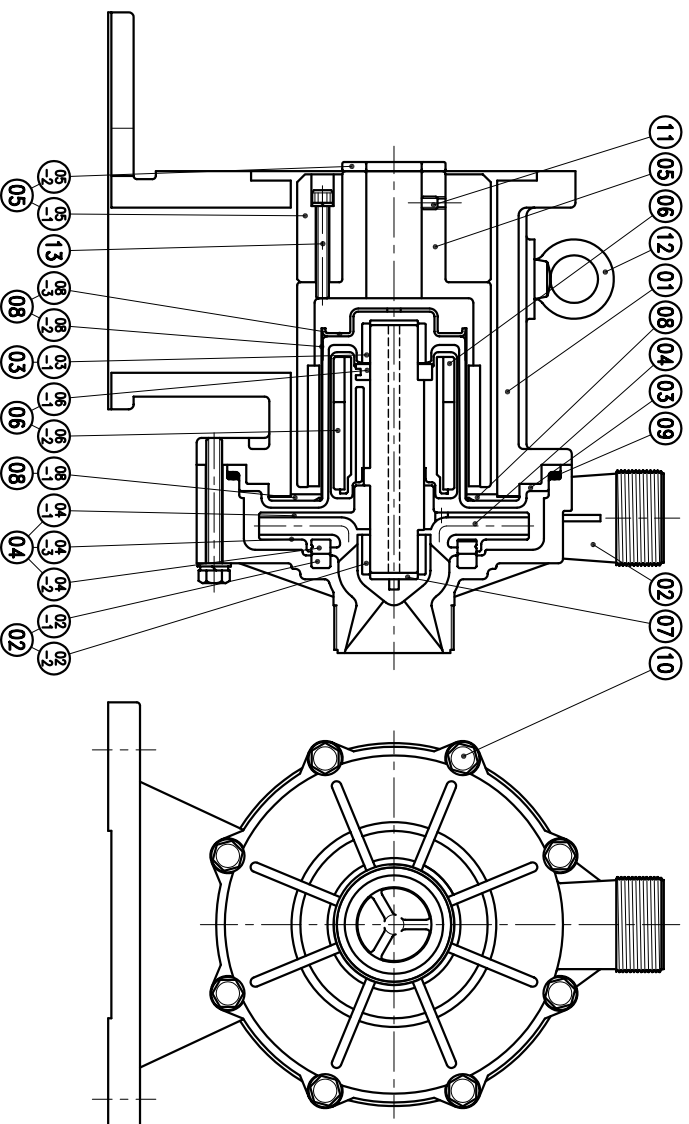

(NEMA)

APPROVED		MDL NAME	NH-5012PH (7.5KW)
CHECK	10 24 03	DWG. NAME	NH-5013PH (7.5KW)
DESIGN	10 24 03	CONSTRUCTION DRAWING	
DR.BY	10 24 03 BECKY	DWG. NO.	E2508345
EDITION	1		A3

TPW
HONG YUAN



PAN WORLD CO., LTD.
パンワールド株式会社