

04	IMPELLER ASS'Y	1	PPS	4012PH	A2408491	08-1	BACK UP RING	1	SUS304	φ158X4	A2118517	16	HEXAGON SOCKET BOLT	4	SUS304	1/2"-13X1 1/4"
				4013PH		08	REAR CASING COVER	1	08-1,-2,-3	φ158X121	A2118477	15	HEXAGON SOCKET BOLT	4	SUS304	M8X60
03-1	BEARING	1	CARBON SIC	φ40X25	A2228423	07	SPINDLE	1	CERAMIC SIC	φ38X156	A2338480	14	HEXAGON SOCKET BOLT	1	SUS304	M12X20
						06-2	DRIVEN MAGNET	1	Nd-Fe-B	φ76X86	A2448494	13	SEI SCREW	2	S435	M8X10
02-4	FLANGE	1	PPG	φ210X123.5	A2308476	06-1	REAR THRUST PAD	1	CERAMIC SIC	φ48X10	A2328512	12	HEXAGON HEAD BOLT	8	SUS304	M10X80
02-3	FLANGE	1	PPG	40A	A2238543											
02-2	BEARING	1	CARBON SIC	φ40X25	A2228423	06	MAGNET CAPSULE	1	PPG	φ79.6X69.5	A2438472	11	O. RING	1	FKM	φ39.5Xφ2
						05-2	RING	1	S45C	φ65X5.7	P2574346	10	O. RING	1	FKM	φ49.5Xφ2
02-1	FRONT THRUST PAD	1	CERAMIC SIC	φ104X9	P2224475	05-1	FLY WHEEL	1	S45C	φ122X68	A2538511	09	O. RING	1	FKM	φ199.3Xφ5.7
						04-3	SHLOUD	1	FCD-45	φ122X199	A2508572	08-3	COVER	1	SUS304	φ90.2X17.5
02	FRONT CASING	1	PPS	φ226.5X118.5	A2208461	04-2	MOUTH RING	1	PPS	φ170X12	A2458481	08-2	PIPE	1	HASTELLOY C	φ91.4X112
01	BRACKET	1	FC-20	φ226.5X184.5	A2128571	04-1	IMPELLER	1	RULON	φ170X41	A2418482					

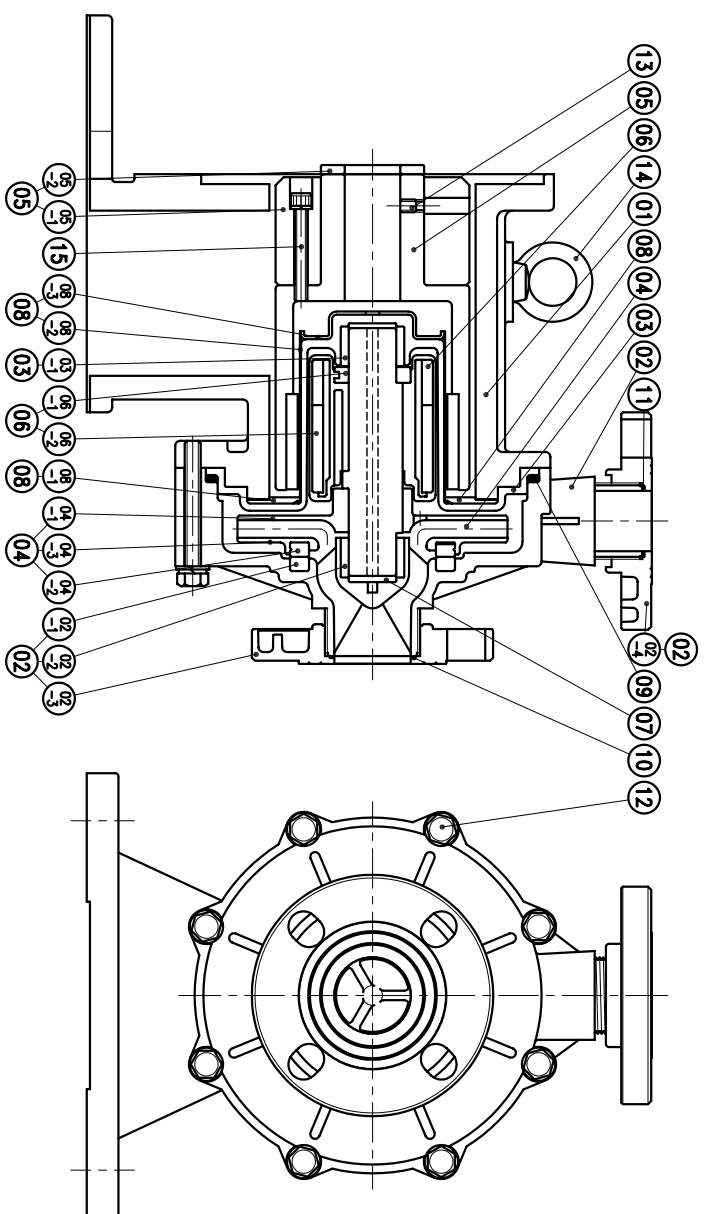

(NEMA)

APPROVED	09 27 03	CHECK	09 27 03	DESIGN	11 27 02	DR.BY	09 27 03 BECKY
MDL NAME	NH-4012PH (5.5KW)						
DWG. NAME	NH-4013PH (5.5KW)						
DWG. NO.	E2408263						
CONSTRUCTION DRAWING	A3						

TPW
HONG YUAN

PAN WORLD CO., LTD.
PANワールド株式会社