

03-1	BEARING	1	CARBON	φ40X25	A2228423
		1	SIC		
03	REAR CASING	1	PPS	φ210X123.5	A2308476
		1	PPG	40A	A2238543
02-3	FLANGE	1	PPG	50A	A2238547
02-2	BEARING	1	CARBON	φ40X25	A2228423
		1	SIC		
02-1	FRONT THRUST PAD	1	CERAMIC	φ104X9	P2224475
		1	SIC		
02	FRONT CASING	1	PPS	φ226.5X118.5	A2208461
01-1	TRANSITION FLANGE	1	FC-20	φ228.6X18	P2179307
01	BRACKET	1	FC-20	φ226.5X183.5	A2128569

08	REAR CASING COVER	1	08-1,-2,-3	φ158X121	A2118477
		1	CERAMIC		
07	SPINDLE	1	SIC	φ38X156	A2358480
06-2	DRIVEN MAGNET	1	Nd-Fe-B	φ76X86	A2448531
		1	CERAMIC		
06-1	REAR THRUST PAD	1	SIC	φ48X10	A2328512
		1	PPG	φ79.6X92	A2438472
06	MAGNET CAPSULE	1	S45C	φ48X9.8	P2509342
		1	FCD-45	φ122X179	A2508570
05-1	RING	1	PPS	φ170X12	A2458481
		1	PPS	φ104X9	A2428549
04-3	SHLOUD	1	RULON	φ170X41	A2418462
		1	PPS	φ170X41	A2418462
04-2	MOUTH RING	1	PPS	φ170X41	A2418462
		1	PPS	φ170X41	A2418462
04-1	IMPELLER	1	PPS	φ170X41	A2418462
		1	PPS	φ170X41	A2418462
04	IMPELLER ASS'Y	1	PPS	4012PH	A2408491
		1	PPS	4013PH	A2408491
08-1	REAR CASING COVER	1	08-1,-2,-3	φ158X121	A2118477
		1	CERAMIC		
16	HEXAGON SOCKET BOLT	4	SUS304	1/2"-13X3/4"	
		4	S435	M10X25	P9119375
15	COUNTER SUNK HEAD BOLT	2	S435	M6X10	P9116430
		2	S435	M8X10	P9119160
13	SET SCREW	2	S435	M8X10	P9119160
		2	S435	M8X10	P9119160
12	HEXAGON HEAD BOLT	8	SUS304	M10X80	P9113080
		8	SUS304	M10X80	P9113080
11	RING	1	FKM	φ39.5Xφ2	S40
		1	FKM	φ49.5Xφ2	S50
10	RING	1	FKM	φ199.3Xφ5.7	G200
		1	FKM	φ199.3Xφ5.7	G200
09	RING	1	SUS304	φ90.2X17.5	A2118518
		1	SUS304	φ90.2X17.5	A2118518
08-2	PIPE	1	HASTELLOY C	φ91.4X112	A2118474
		1	SUS304	φ158X4	A2118517
08-1	BACK UP RING	1	SUS304	φ158X4	A2118517
		1	SUS304	φ158X4	A2118517

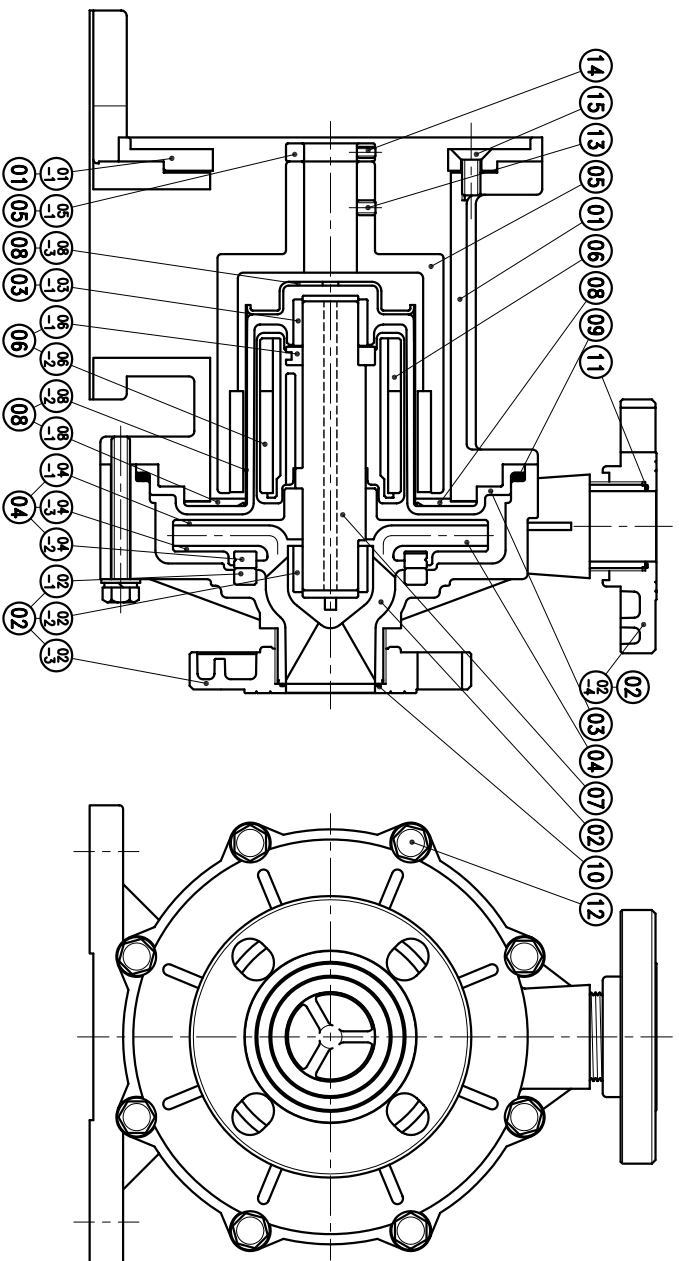

(NEMA)

APPROVED		MDL NAME	NH-4012PH (3.7kW)
CHECK	09 27 03	DWG. NAME	NH-4013PH (3.7kW)
DESIGN	11 27 02	CONSTRUCTION DRAWING	
DR.BY	09 27 03 BECKY	DWG. NO.	E2408262
EDITION	1		A3

TPW  
HONG YUAN



PAN WORLD CO., LTD.  
パンワールド株式会社