

04	IMPELLER ASS'Y	1	PPS	4012PH	A2408491	08	REAR CASING COVER	1	08-1,-2,-3	φ158X121	A2118477	14	HEXAGON SOCKET BOLT	4	SUS304	3/8"-16X1"	
			CARBON	φ40X25	A2228423	07	SPINDLE	1		φ38X156	A2338480	13	COUNTER SUNK HEAD BOLT	4	S435	M10X20	
03-1	BEARING	1	SIC											2	S435	M6X10	
03	REAR CASING	1	PPS	φ210X123.5	A2308476	06-2	DRIVEN MAGNET	1	ND-Fe-B	φ76X86	A2448530	12	SET SCREW	2	S435	M6X10	
02-2	BEARING	1	CARBON	φ40X25	A2228423	06-1	REAR THRUST PAD	1	CERAMIC	φ48X10	A2328512	11	SET SCREW	2	S435	M8X10	
			SIC														
02-1	FRONT THRUST PAD	1	CERAMIC	φ104X9	P2224475	06	MAGNET CAPSULE	1	PPG	φ79.6X92	A2438472	10	HEXAGON HEAD BOLT	8	SUS304	M10X80	
			SIC			05-1	RING	1	S45C	φ44X10	P2579340		w/1 S.W.(M10)			P9113080	
02	FRONT CASING	1	PPS	φ226.5X118.5	A2208461	05	DRIVE MAGNET	1	FCD-45	φ118X169	A2508574	09	O. RING	1	FKM	φ199.3Xφ5.7	
01-1	TRANSITION FLANGE	1	FC-20	φ165.1X14	P2179302	04-3	SHLOUD	1	PPS	φ170X12	A2458481	08-3	COVER	1	SUS304	φ90.2X17.5	
01	BRACKET	1	FC-20	φ226.5X173.5	A2128573	04-2	MOUTH RING	1	RULON	φ104X9	A2428549	08-2	PIPE	1	HASTELLOY C	φ91.4X112	
						04-1	IMPELLER	1	PPS	φ170X41	A2418462	08-1	BACK UP RING	1	SUS304	φ158X4	
																A2118517	
NO	PART NAME	Q'TY	MATERIAL	NOTE	DWG. NO.	NO	PART NAME	Q'TY	MATERIAL	NOTE	DWG. NO.	NO	PART NAME	Q'TY	MATERIAL	NOTE	DWG. NO.

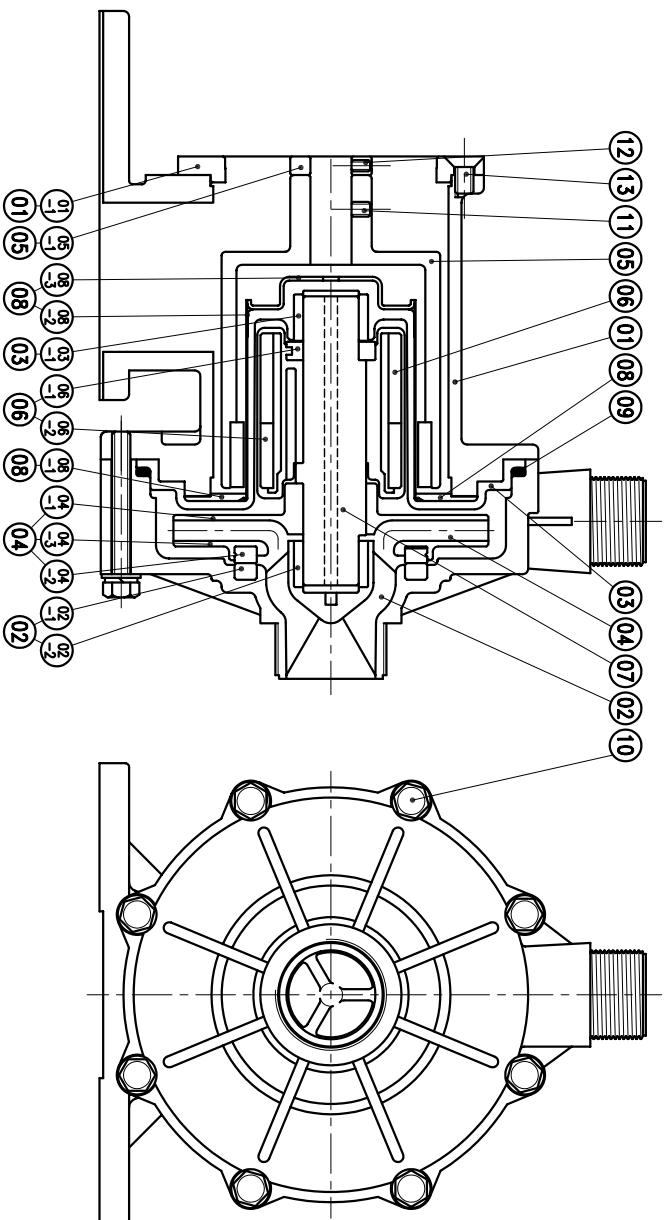

(NEMA)

APPROVED		MDL NAME	NH-4012PH (2.2KW)
CHECK	11 15 03	DWG. NAME	CONSTRUCTION DRAWING
DESIGN	11 27 02	DWG. NO.	E2408258
DR.BY	11 15 03 BECKY		A3

TPW
HONG YUAN



PAN WORLD CO., LTD.
パンワールド株式会社