

| 04-1 | IMPELLER-1ST | 1 | PPS | φ170X33 | A2418427 | 07 | SPINDLE | 1 | CERAMIC | φ30X164 | A2338425 | 15 | HEXAGON SOCKET BOLT | 4 | SUS304 | 1/2"-13X3/4" | |
|------|--------------------|------|----------|-------------|----------|------|--------------------|------|----------|------------|----------|------|------------------------|------|-------------|--------------|--------------|
| 04-A | IMPELLER ASS'Y-1ST | 1 | PPS | 3024PH | A2408522 | 06-2 | DRIVEN MAGNET | 1 | Nd-Fe-B | φ76X56.5 | A2448447 | 14 | COUNTER SUNK HEAD BOLT | 4 | S435 | M10X25 | P9119375 |
| | | | | 3026PH | | | | | | | | | | | | | |
| 03-1 | BEARING | 1 | CARBON | φ34X20 | A2228471 | 06-1 | REAR THRUST PAD | 1 | CERAMIC | φ42X10 | A2328424 | 13 | SET SCREW | 2 | S435 | M6X10 | P9116430 |
| | | | | SIC | | | | | | | | | | | | | |
| 03 | REAR CASING | 1 | PPS | φ210X90 | A2308468 | 06 | MAGNET CAPSULE | 1 | PGC | φ79.6X63.5 | A2438435 | 11 | HEXAGON HEAD BOLT | 8 | SUS304 | M10X95 | P9113080 |
| | | | | φ226.5X41 | A2208442 | | | | | φ48X9.8 | P2509342 | | | | | | |
| 02-B | CASING-2ND | 1 | PPS | φ226.5X41 | A2208442 | 05-1 | RING | 1 | S45C | φ118X144 | A2508499 | 10 | O. RING | 2 | FKM | φ139.3Xφ5.7 | G200 |
| | | | | SIC | | | | | | | | | | | | | |
| 02-2 | BEARING | 1 | CARBON | φ34X20 | A2228471 | 04-3 | SHLOUD-2ND | 1 | PPS | φ170X13 | A2458488 | 09 | DEFUSER | 1 | PPS | φ195X18 | A2638539 |
| | | | | SIC | | | | | | | | | | | | | |
| 02-1 | FRONT THRUST PAD | 1 | CERAMIC | φ72X9 | P2229315 | 04-1 | IMPELLER-2ND | 1 | PPS | φ170X33 | A2418427 | 08-3 | COVER | 1 | SPCC | φ91.4X12.5 | A2118470 |
| | | | | SIC | | | | | | | | | | | | | |
| 02-A | FRONT CASING-1ST | 1 | PPS | φ226.5X97.5 | A2208440 | 04-B | IMPELLER ASS'Y-2ND | 1 | PPS | 3024PH | A2408487 | 08-2 | PIPE | 1 | HASTELLOY C | φ91.4X82 | A2118469 |
| | | | | φ228.6X18 | P2179307 | | | | | φ170X13 | A2458421 | | | | | 08-1 | BACK UP RING |
| 01-1 | TRANSITION FLANGE | 1 | FC-20 | φ226.5X151 | A2128502 | 04-3 | SHLOUD-1ST | 1 | PPS | φ170X13 | A2458421 | 08-1 | BACK UP RING | 1 | SUS304 | φ145X5 | A2118473 |
| 01 | BRACKET | 1 | FC-20 | φ226.5X151 | A2128502 | 04-2 | MOUTH RING | 1 | RULON | φ63X8 | P2429006 | 08 | REAR CASING COVER | 1 | 08-1,-2,-3 | φ145X88 | A2118458 |
| NO | PART NAME | Q'TY | MATERIAL | NOTE | DWG. NO. | NO | PART NAME | Q'TY | MATERIAL | NOTE | DWG. NO. | NO | PART NAME | Q'TY | MATERIAL | NOTE | DWG. NO. |

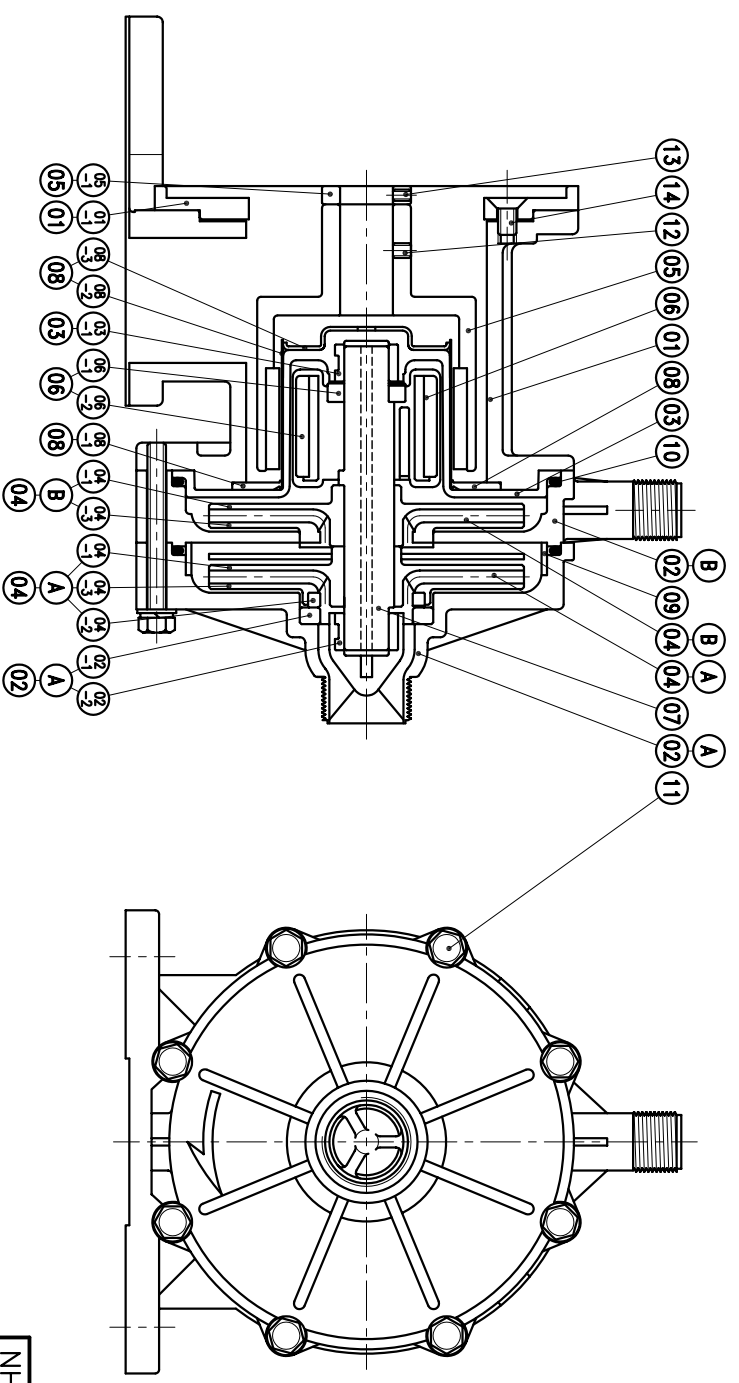

(NEMA)

| | | | | |
|----------|--------|----------------|-----------|-------------------|
| APPROVED | CHECK | 07 29 03 | MDL NAME | NH-3024PH (3.7KW) |
| CHECK | DESIGN | 11 27 02 | DWG. NAME | NH-3026PH (3.7KW) |
| DESIGN | DR.BY | 07 29 03 BECKY | DWG. NO. | E2308152 |
| DR.BY | | | | A3 |

TPW
HONG YUAN

PAN WORLD CO., LTD.
PANワールド株式会社