

03-1	BEARING	1	CARBON SiC	φ34X20	A2228471	06-2	DRIVEN MAGNET	1	Nd-Fe-B CERAMIC	φ76X56.5	A2448446	14	HEXAGON SOCKET BOLT w/1 S.W.(3/8")	4	SUS304	3/8"-13X1"	
03	REAR CASING	1	PPS	φ210X90	A2308526	06-1	REAR THRUST PAD	1	SiC	φ42X10	A2328424	13	COUNTER SUNK HEAD BOLT	4	S435	M10X20 P9119375	
02-2	BEARING	1	CARBON SiC	φ34X20	A2228471	06	MAGNET CAPSULE	1	PPG	φ79.6X63.5	A2438435	12	SET SCREW	2	S435	M6X10 P9116430	
02-1	FRONT THRUST PAD	1	CERAMIC SiC	φ72X9	P2229315	05-1	RING	1	S45C	φ44X10	P2579340	11	SET SCREW	2	S435	M8X10 P9119160	
02	FRONT CASING	1	PPS	φ226.5X103.5	A2208508	05	DRIVE MAGNET	1	FCD-45	φ118X133	A2508500	10	HEXAGON HEAD BOLT w/1 S.W.(M10)	8	SUS304	M10X60 P9113080	
01-1	TRANSITION FLANGE	1	FC-20	φ165.1X14	P2179302	04-3	SHLOUD	1	PPS	φ170X13	A2458421	09	O. RING	1	FKM	φ199.3Xφ5.7 G200	
01	BRACKET	1	FC-20	φ226.5X140	A2128501	04-2	MOUTH RING	1	RULON	φ63X8	P2429006	08	BACK UP RING	1	SUS304	φ145X4 A2118437	
NO	PART NAME	Q'TY	MATERIAL	NOTE	DWG. NO.	04	IMPELLER ASS'Y	1	PPS	3013PH	A2408448	07	SPINDLE	1	CERAMIC SiC	φ30X131 A2338425	
NO	PART NAME	Q'TY	MATERIAL	NOTE	DWG. NO.	NO	PART NAME	Q'TY	MATERIAL	NOTE	DWG. NO.	NO	PART NAME	Q'TY	MATERIAL	NOTE	DWG. NO.

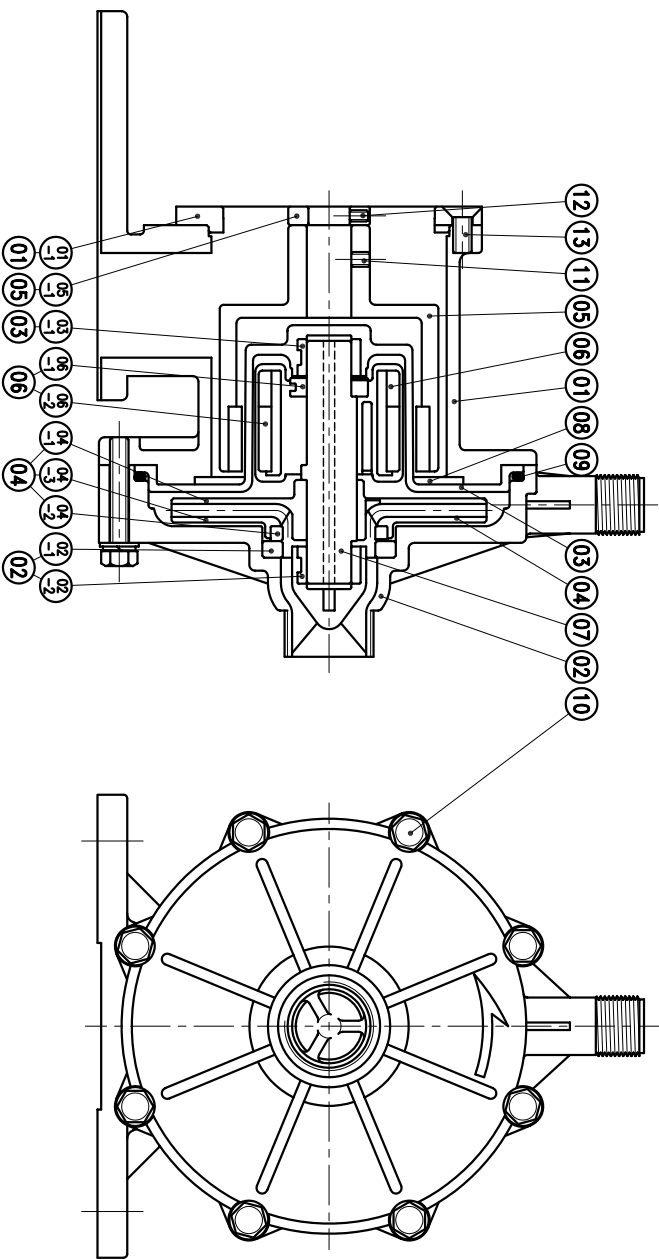

(NEMA)

APPROVED	CHECK	07 29 03	MDL NAME	NH-3012PH (1.5kW)
DESIGN	DESIGN	11 27 02	DWG. NAME	NH-3012PH (2.2kW)
DR.BY	DR.BY	07 29 03 BECKY	DWG. NO.	E2308151
EDITION	2			A3

TPW  
HONG YUAN

**PAN WORLD CO.,LTD.**  
PANワールド株式会社