

06	BEARING ASS'Y	1	SIC	φ76X42	6573510117	22	IMPELLER NUT	1	SUS316	M12(L)	6573510158	35	SPRING WASHER	1	SUS316	M10		
05-1	FLY WHEEL	1	S45C	φ139X75	6573510135	21	IMPELLER NUT	1	SUS316	M12(R)	6573510157	34	SPRING WASHER	2	SUS316	M12		
05	OUTER DRIVE RING	1	FCD-45	φ122X202.5	6573510131	20	IMPELLER NUT	1	SUS316	M12		33	HEXAGON SOCKET BOLT	3	SUS304	M12X45		
04	IMPELLER	1	SUS316	100PG:φ100	6573510106	19	EYE BOLT	1	S41C	M12X20			32	HEXAGON SOCKET BOLT	6	SUS304	M12X40	
				120PG:φ120	6573510107	18	SET SCREW	2	S435	M8X10								
				140PG:φ140	6573510108	17	O. RING	1	FKM	G210	6573510102							
				160PG:φ160	6573510109	16	O. RING	1	FKM	G100	6573510138							
03	REAR CASING	1	SUS316	180PG:φ180	6573510110	15	O. RING	1	FKM	G35	6573510142	30	HEXAGON SOCKET BOLT	4	SUS304	M8X60		
				200PG:φ200	6573510111	14	THRUST PAD ASS'Y	1	SIC	φ76X9	6573510113							
				210PG:φ210	6573510112	13	CENTER PLATE	1	SUS316	φ225X22	6573510160							
02	FRONT CASING	1	SUS316	ANSI 300lb6	6573510105	12	REAR SLEEVE	1	SIC	φ35X10		29	HEXAGON SOCKET BOLT	6	SUS304	M6X12		
				φ150X125.5	6573510105	11	REAR SLEEVE HOLDER	1	SUS316	φ66X34.5								
01-2	TRANSITION FLANGE	1	S45C	φ228.6X75.7		10	FIXING PLATE	1	SUS316	φ32X8	6573510159	27	HEXAGON SOCKET BOLT	6	SUS316	M6X8		
				280X195	6573510156	09	SLEEVE	1	SIC	φ26X40	6573510125	26	HEXAGON HEAD BOLT	1	SUS316	1/4"-20X3/4"		
01	BRACKET	1	FC-20	φ270X144	6573510153	08	SPINDLE	1	SUS316	φ22X152	6573510127	25	HEXAGON HEAD BOLT	4	SUS304	M6X6		
						07-1	REAR BEARING COVER	1	SUS316	φ77X10.5		24	KEY	1	SUS316	6X6X25		
						07	INNER DRIVE RING	1	SUS316	φ77.2X98.5	6573510122	23	KEY	1	SUS316	5X5X20		

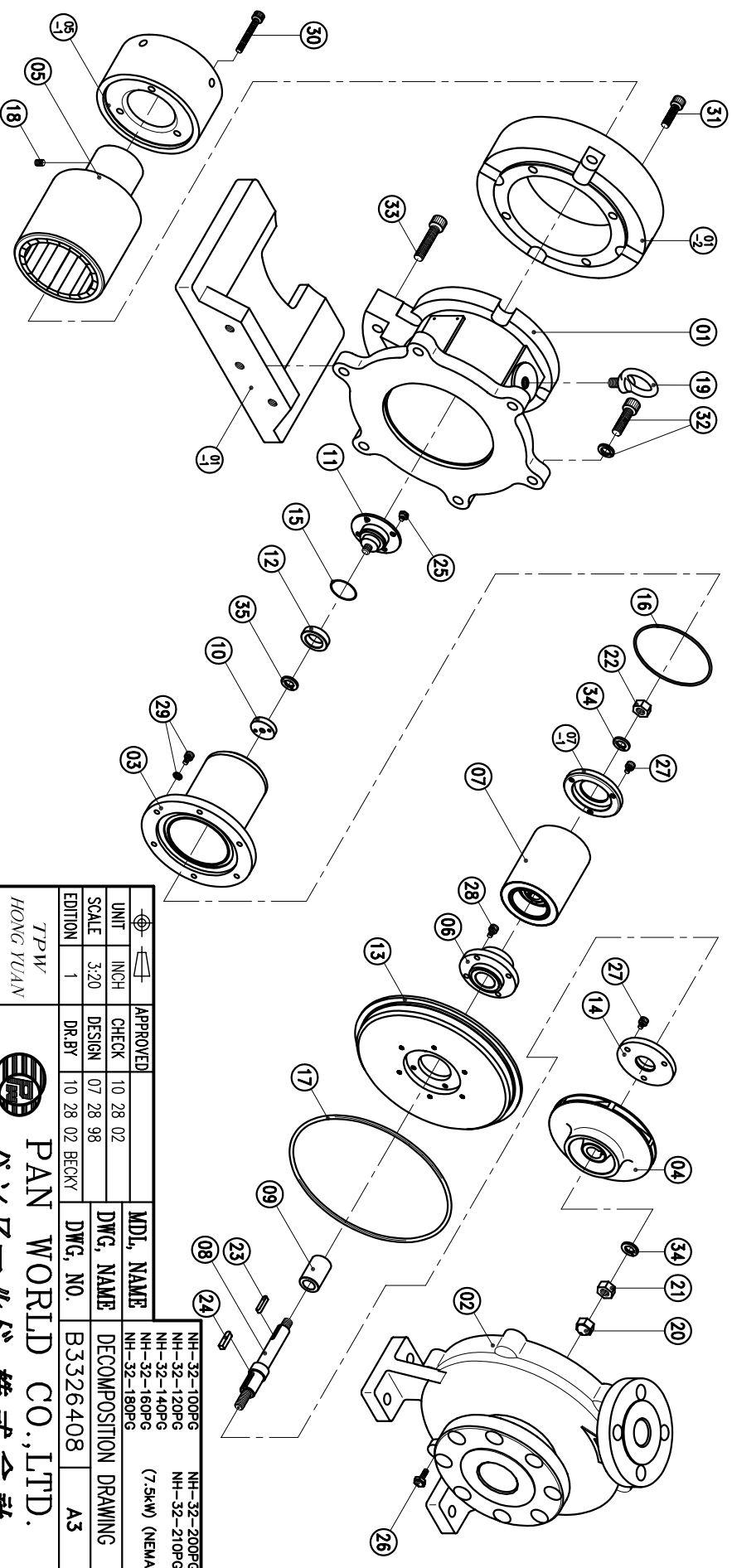

APPROVED	10 28 02	CHECK	10 28 02	UNIT	INCH
MDL NAME		DWG. NAME		SCALE	3:20
DECOMPOSITION DRAWING		DWG. NO.	B3326408	EDITION	1
		DR.BY	10 28 02 BECKY		

NH-32-100PG	NH-32-200PG
NH-32-120PG	NH-32-120PG
NH-32-140PG	NH-32-210PG
NH-32-160PG	(7.5kW) (NEMA)
NH-32-180PG	

TPW  
HONG YUAN



PAN WORLD CO., LTD.  
パンワールド株式会社