

| | | | | | | | | | | | | | | | | | |
|------|-------------------|-----|----------|---------------|----------|------|------------------------|-----|-------------|-------------|----------|----|---------------------|-----|----------|--------------|---------|
| 07-1 | THRUST PAD | 1 | SIC | 040X7 | P2426976 | 19 | EYE BOLT | 1 | S41C | M12X20 | | 35 | SPRING WASHER | 1 | SUS316 | M10 | |
| 07 | INNER DRIVE RING | 1 | SIC | 077.2X82.5 | P2436450 | 18 | SET SCREW | 2 | S435 | M8X10 | | 34 | SPRING WASHER | 2 | SUS316 | M12 | |
| 06-2 | BEARING | 1 | SIC | 040X42 | P2466396 | 17 | O. RING | 1 | FKM | 0209.3X05.7 | G210 | 33 | HEXAGON SOCKET BOLT | 3 | SUS304 | M12X45 | |
| 06-1 | HOUSING, BEARING | 1 | SUS316 | 076X36 | P2466398 | 16 | O. RING | 1 | FKM | 099.4X03.1 | G100 | | w/t S.W. (M12) | | | | |
| 06 | BEARING ASS'Y | 1 | | 076X42 | P2466406 | 15 | O. RING | 1 | FKM | 034.4X03.1 | G35 | 32 | HEXAGON SOCKET BOLT | 6 | SUS304 | M12X40 | |
| 05-1 | FLY WHEEL | 1 | S45C | 0139X7.5 | P2536439 | 14-2 | REAR THRUST PAD | 1 | SIC | 040X7 | P2426390 | | w/t S.W. (M12) | | | | |
| 05 | OUTER DRIVE RING | 1 | FCD-45 | 0122X187 | A2506200 | 14-1 | HOUSING, THRUST PAD | 1 | SUS316 | 076X8 | P2426389 | 31 | HEXAGON SOCKET BOLT | 4 | SUS304 | M10X35 | |
| 04 | IMPELLER | 1 | SUS316 | 120PG,0120X40 | P2416380 | 14 | THRUST PAD ASS'Y | 1 | | 076X9 | P2426388 | 30 | HEXAGON SOCKET BOLT | 3 | SUS304 | M8X60 | |
| | | | | 140PG,0140X40 | | 13 | CENTER PLATE | 1 | | 0225X22 | P2616385 | | w/t S.W. (M8) | | | | |
| | | | | 160PG,0160X40 | | 12 | REAR SLEEVE | 1 | SIC | 035X10 | A2376183 | 29 | HEXAGON SOCKET BOLT | 6 | SUS304 | M6X12 | |
| | | | | | | 11 | REAR SLEEVE HOLDER | 1 | SUS316 | 066X34.5 | P2376928 | | w/t S.W. (M6) | | | | |
| 03-3 | REAR CASING COVER | 1 | SUS316 | 086X10.5 | P2376395 | 10 | FIXING PLATE | 1 | SUS316 | 032X8 | P2376407 | 28 | HEXAGON SOCKET BOLT | 4 | SUS316 | M6X10 | |
| 03-2 | REAR CASING PIPE | 1 | SUS316 | 086X96 | P2376444 | 09 | SLEEVE | 1 | SIC | 026X40 | P2466397 | 27 | HEXAGON SOCKET BOLT | 6 | SUS316 | M6X8 | |
| 03-1 | REAR CASING RING | 1 | SUS316 | 0150X11.9 | P2376393 | 08 | SPINDLE | 1 | SUS316 | 022X152 | P2336455 | 26 | HEXAGON HEAD BOLT | 1 | SUS316 | 1/4"-20X3/4" | |
| 03 | REAR CASING ASS'Y | 1 | | | | 07-7 | INNER MG-HOUSING PIPE | 1 | HASTELLOY C | 077.2X74.5 | P2476449 | 25 | HEXAGON HEAD BOLT | 4 | SUS304 | M6X6 | |
| 02 | FRONT CASING | 1 | SUS316 | ANSI 300lb | P2216523 | 07-6 | INNER MG-HOUSING COVER | 1 | SUS316 | 076X3 | P2476402 | 24 | KEY | 1 | SUS316 | 6X6X25 | |
| 01-2 | TRANSITION FLANGE | 1 | FC-20 | 0228.6X47 | A2176197 | 07-5 | REAR BEARING COVER | 1 | SUS316 | 077X10.5 | A2476256 | 23 | KEY | 1 | SUS316 | 5X5X20 | |
| 01-1 | FOOT | 1 | FCD-45 | 280X195 | P2179157 | 07-4 | REAR BEARING | 1 | SIC | 047X10 | A2466182 | 22 | IMPELLER NUT | 1 | SUS316 | M12(L) | |
| 01 | BRACKET | 1 | FC-20 | 0270X144 | A2126196 | 07-3 | INNER MAGNET | 1 | Nd-Fe-B | 076X61.5 | P2446445 | 21 | IMPELLER NUT | 1 | SUS316 | M12(R) | |
| NO | PART NAME | QTY | MATERIAL | NOTE | DWG NO. | NO | PART NAME | QTY | MATERIAL | NOTE | DWG NO. | NO | PART NAME | QTY | MATERIAL | NOTE | DWG NO. |

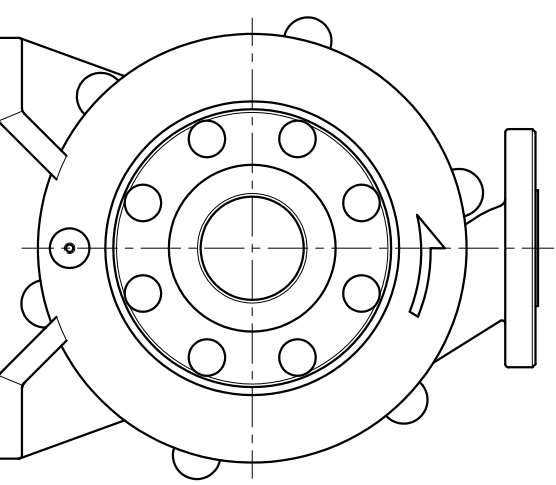
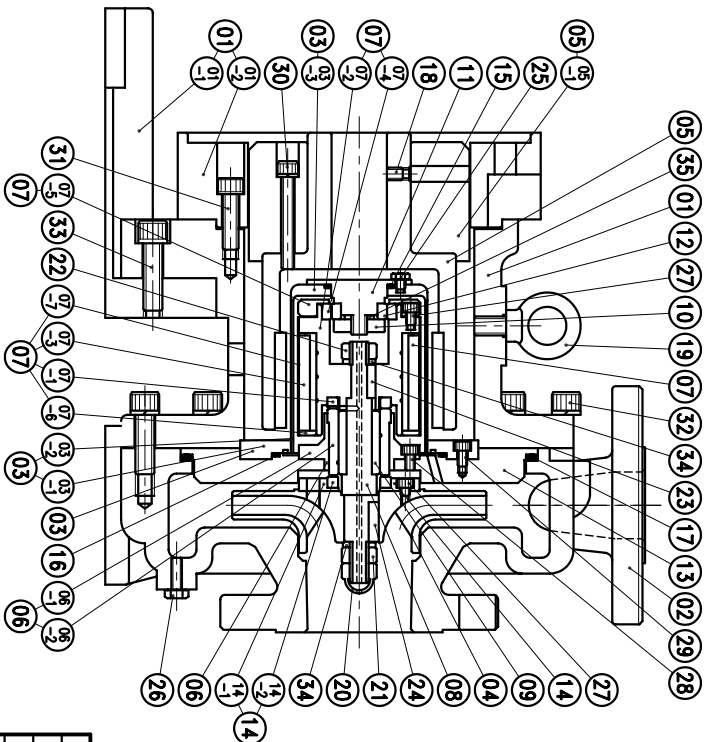

| | | | | |
|----------|----------|----------------------|-------------|----------------|
| APPROVED | 12 12 02 | MDL NAME | NH-40-100PG | NH-40-140PG |
| CHECK | 10 04 99 | DWG. NAME | NH-40-120PG | NH-40-160PG |
| DESIGN | 12 12 02 | CONSTRUCTION DRAWING | | (5.5kW) (NEMA) |
| DR.BY | 12 12 02 | DWG. NO. | B2406693 | A3 |

TPW
HONG YUAN

PAN WORLD CO., LTD.
パンワールド株式会社