

06-2	BEARING	1	SIC	φ40X42	P2466396	18	SET SCREW	2	S435	M8X10	35	SPRING WASHER	1	SUS316	M10	
06-1	HOUSING, BEARING	1	SUS316	φ76X36	P2466398	17	O. RING	1	FKM	φ209.3Xφ5.7	G210	34	SPRING WASHER	2	SUS316	M12
06	BEARING ASS'Y	1		φ76X42	P2466406	16	O. RING	1	FKM	φ99.4Xφ3.1	G100	33	HEXAGON SOCKET BOLT	3	SUS304	M12X45
05-1	FLY WHEEL	1	S45C	φ139X96.6	A2536219	15	O. RING	1	FKM	φ34.4Xφ3.1	G35					
05	OUTER DRIVE RING	1	FCD-45	φ122X232.6	A2506201	14-2	REAR THRUST PAD	1	SIC	φ40X7	P2426390	32	HEXAGON SOCKET BOLT	6	SUS304	M12X40
						14-1	HOUSING, THRUST PAD	1	SUS316	φ76X8	P2426389	31	HEXAGON SOCKET BOLT	4	SUS304	M10X35
						14	THRUST PAD ASS'Y	1		φ76X9	P2426388					
						13	CENTER PLATE	1	SUS316	φ225X22	P2616385	30	HEXAGON SOCKET BOLT	3	SUS304	M8X70
						12	REAR SLEEVE	1	SIC	φ35X10	A2376183					
						11	REAR SLEEVE HOLDER	1	SUS316	φ66X34.5	P2376928	29	HEXAGON SOCKET BOLT	6	SUS304	M6X12
						10	FIXING PLATE	1	SUS316	φ32X8	P2376407					
						09	SLEEVE	1	SIC	φ26X40	P2466397	28	HEXAGON SOCKET BOLT	4	SUS316	M6X10
						08	SPINDLE	1	SUS316	φ22X152	P2336455	27	HEXAGON SOCKET BOLT	6	SUS316	M6X8
						07-7	INNER MG. HOUSING PIPE	1	HASTELLOY C	φ77.2X105	P2476460	26	HEXAGON HEAD BOLT	1	SUS316	1/4"-20X3/4"
						07-6	INNER MG. HOUSING COVER	1	SUS316	φ76X3	P2476402	25	HEXAGON HEAD BOLT	4	SUS304	M6X6
						07-5	REAR BEARING COVER	1	SUS316	φ77X10.5	A2476256	24	KEY	1	SUS316	6X6X25
						07-4	REAR BEARING	1	SIC	φ47X10	A2466182	23	KEY	1	SUS316	5X5X20
						07-3	INNER MAGNET	1	Nd-Fe-B	φ76X92	P2446458	22	IMPELLER NUT	1	SUS316	M12(L)
						07-2	INNER MAGNET HOUSING	1	SUS316	φ76X113	P2436459	21	IMPELLER NUT	1	SUS316	M12(R)
						07-1	THRUST PAD	1	SIC	φ40X7	P2426976	20	IMPELLER NUT	1	SUS316	M12
						07	INNER DRIVE RING	1		φ77.2X113	P2436461	19	EYE BOLT	1	S41C	M12X20

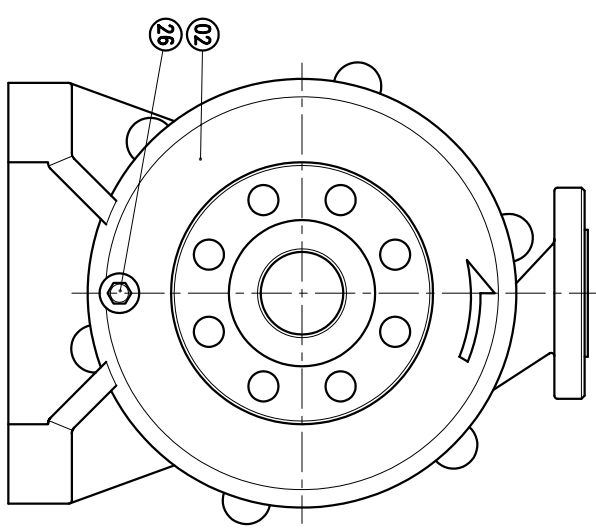
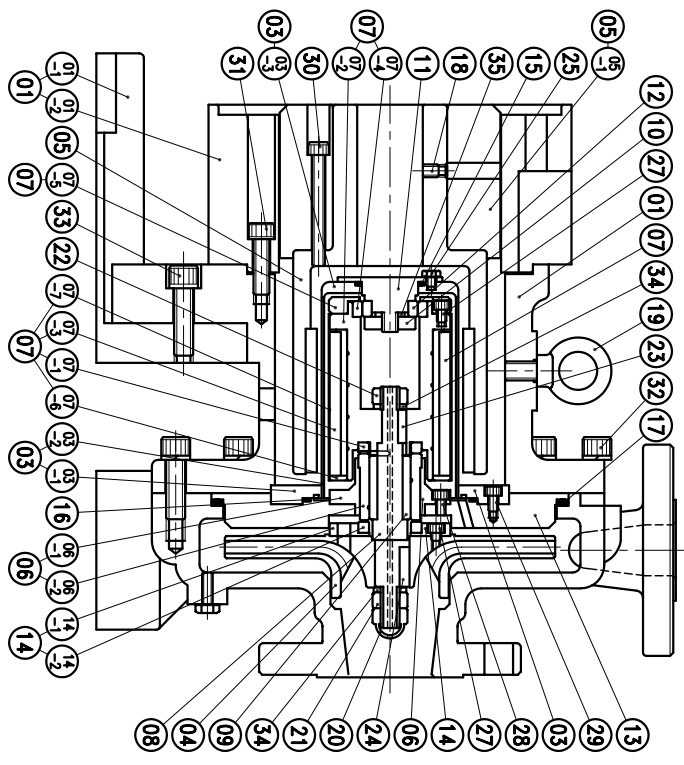

APPROVED	12 12 02	MDL NAME	NH-32-100PG	NH-32-140PG
CHECK	10 04 99	DWG. NAME	NH-32-120PG	NH-32-160PG
DESIGN		CONSTRUCTION DRAWING	NH-32-180PG	NH-32-200PG
DR.BY	12 12 02 BECKY	DWG. NO.	B2326458	NH-32-210PG (11kW) (NEMA)
EDITION	1			

TPW
HONG YUAN

PAN WORLD CO., LTD.
パンワールド株式会社